

TERMINALS SPECIFICATION DRAWING

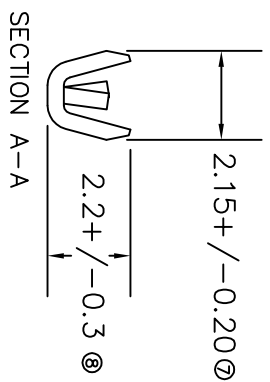
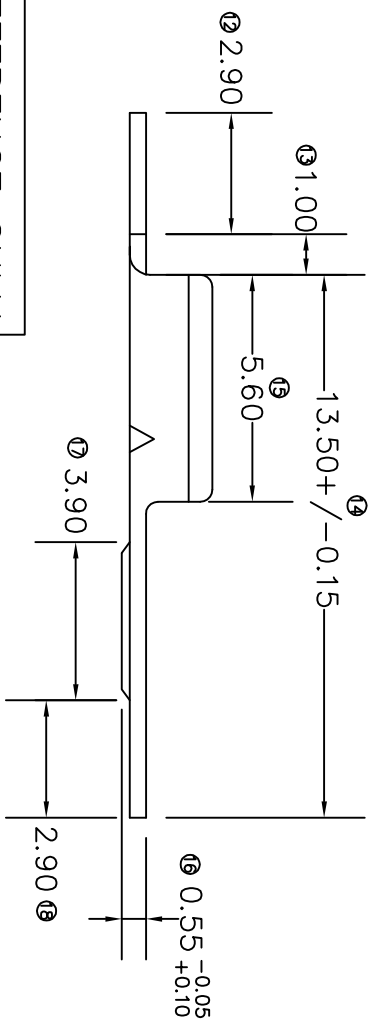
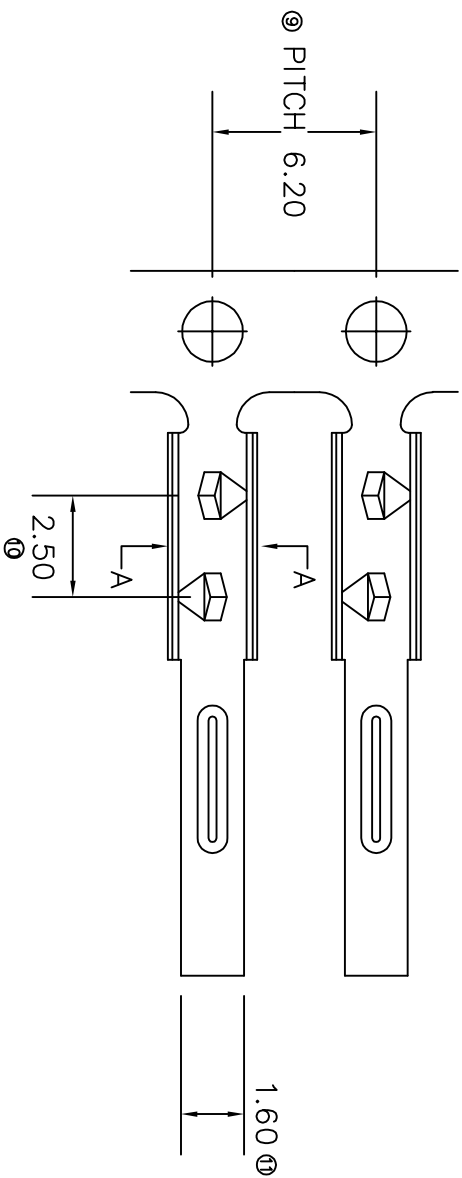

FOR REFERENCE ONLY

- 6) CRIMPING WIRE TENSILE FORCE IS BASE ON COPPER BREAK OFF INTENSITY.
- 5) TEMPERATURE RANGE -40°C TD +120°C.
- 4) VOLTAGE-MAX [VOLTS] PER WIRE SPECIFICATION.
- 3) PACKING QTY : 8000 PCS/REEL.
- 2) WIRE INSULATION (O.D) : 0.95MM.
- 1) APPLICABLE WIRE RANGE : #AWG 26/1061.

SPECIFICATION :

| | | | | | |
|---------------------------------------|----------------------------|---------------------|--------------------------------------|---|--|
| MATERIAL: T0.40 BRASS C2680 | | TREATMENT SELECTIVE | | PART NUMBER 12013-1 | |
| DIMENSIONS : MM | | DWN: KS YEW | | Terminals & Connectors Elamp Precision Industry(M) Sdn.Bhd. | |
| TOLERANCE UNLESS OTHERWISE SPECIFIED: | | CHK: SC CHOO | | | |
| X.XXX | +/-0.05 | APVD: Y.L | PART NAME: | | |
| X.XX | +/-0.10 | SCALE : FREE | SPLICE TERMINALS | | |
| X.X | +/-0.20 | DRAWING NO: | APPLICABLE (1) TERMINALS (2) HOUSING | | |
| X | +/-0.50 | A1407 | (1) - | (2) - | |
| SHEET OF : 1 / 1 | EFFECTIVE DATE : 4/5/07 | | | | |

REVISION:
02

