

TERMINALS SPECIFICATION DRAWING

UNCONTROLLED COPY

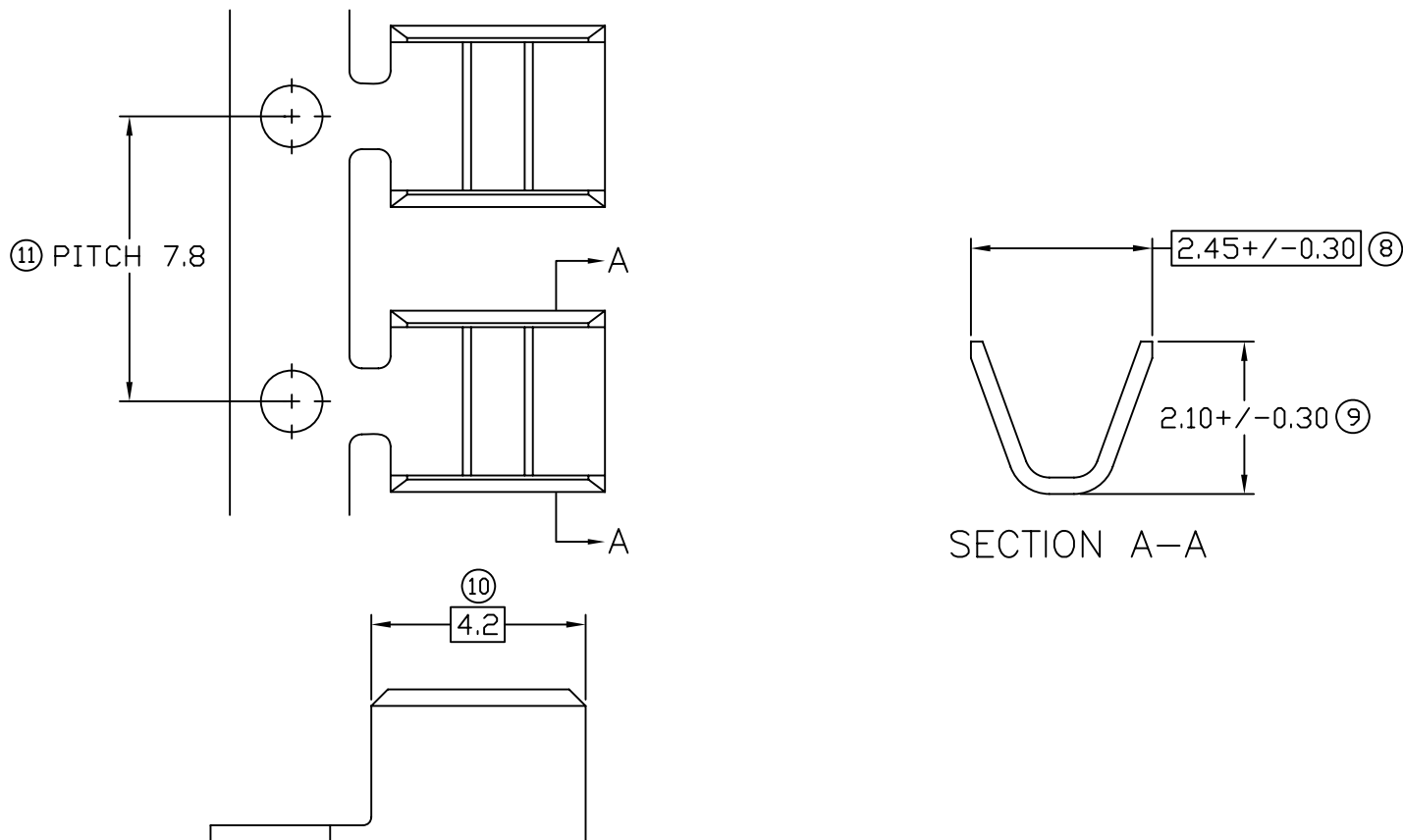

□ CRITICAL DIMENSION

- 7) CRIMPING WIRE TENSILE FORCE IS BASE ON COPPER BREAK OFF INTENSITY.
- 6) TEMPERATURE RANGE -40°C TO +120°C.
- 5) VOLTAGE-MAX [VOLTS] PER WIRE SPECIFICATION.
- 4) THICKNESS PLATING MORE THAN 40μ INCH.
- 3) PACKING QTY : 25000 PCS/REEL.
- 2) WIRE INSULATION (O.D) : - MM.
- 1) APPLICABLE WIRE RANGE : 0.41~0.18MM².

FOR REFERENCE ONLY

SPECIFICATION :

05	13/11/09	1) APPLICABLE WIRE RANGE: 0.412-0.813MM ² CHANGE TO 0.41-0.18MM ²
REV.	DATE	AMENDMENT

REVISION: 05	
SHEET OF : 1 / 1	

MATERIAL: t0.30 BRASS C2680	PRE-TIN PLATED	1219FS-2T
	NONE	1219FS-1
	TREATMENT SELECTIVE	PART NUMBER
DIMENSIONS : MM TOLERANCE UNLESS OTHERWISE SPECIFIED: X.XXX +/-0.05 X.XX +/-0.10 X.X +/-0.20 X +/-0.50	PREPARE BY: KS YEW REVIEWED BY: CH ANG APPROVED BY: YL CHUANG SCALE : FREE DRAWING NO: A1223	EPI Terminals & Connectors Elamp Precision Industry(M) Sdn.Bhd. PART NAME: SPLICE TERMINALS APPLICABLE (1) TERMINALS (2) HOUSING (1) - (2) -
EFFECTIVE DATE : 13/11/09		