

SPECIFICATION DRAWING

MASTER COPY

ITEM NO	MATERIAL	TREATMENT	QTY/REEL	REEL/CARTON	MATCHING PART(S)
13900-2T	t0.3 PBR (C5191)	PRE-TIN PLATED	4000 PCS	6	TERMINAL-26016 HOUSING-MOLEX 964409-8/1

SYMBOL	DESCRIPTION
○	DIMENSION INSPECTED DURING SETUP AND OUTGOING.
□	DIMENSION INSPECTED HOURLY.
SPC	STATISTICALLY CONTROLLED DIMENSION.
△	JIG USED DURING INSPECTION.

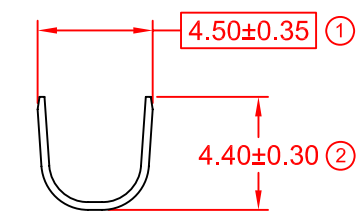
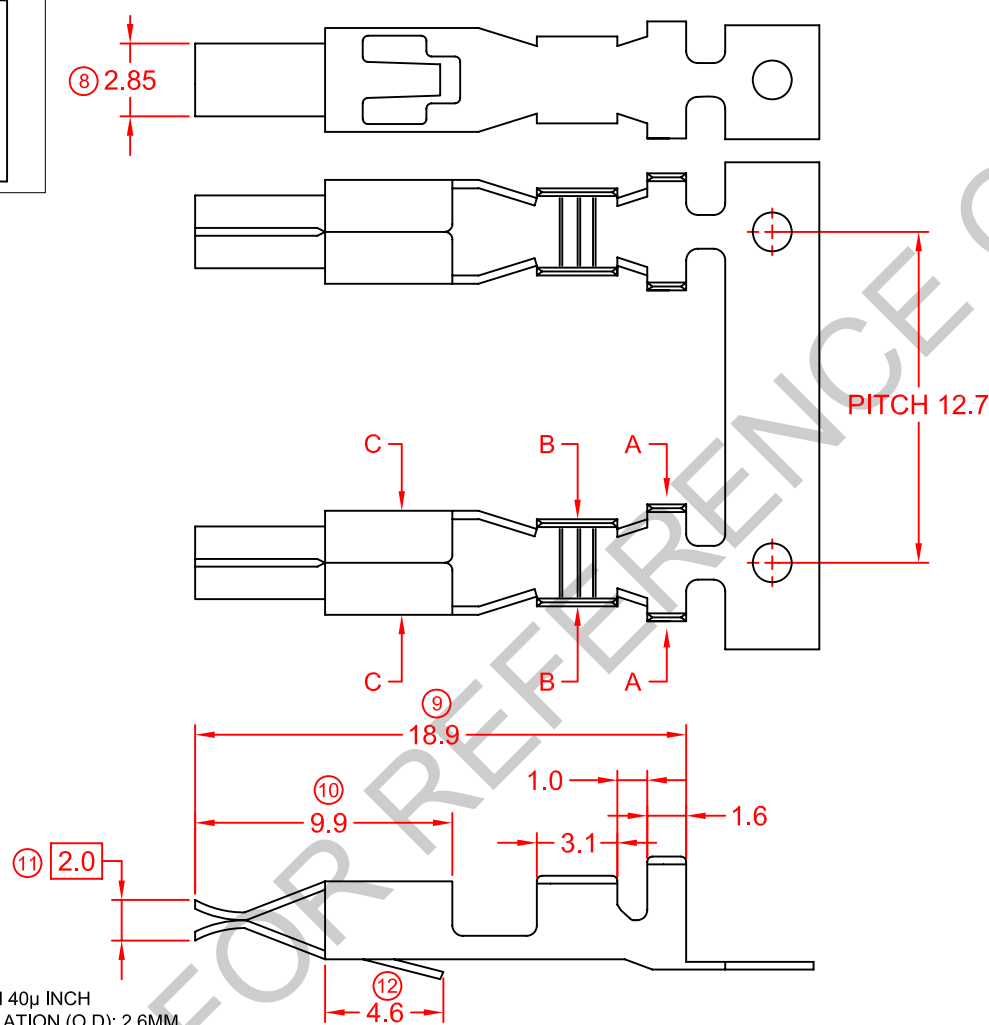
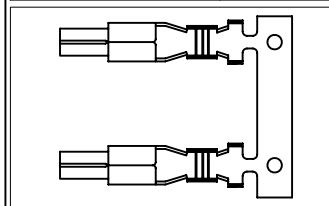

SECTION A-A

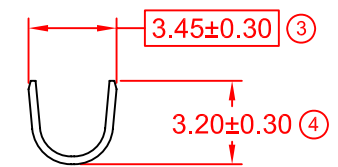

SECTION B-B

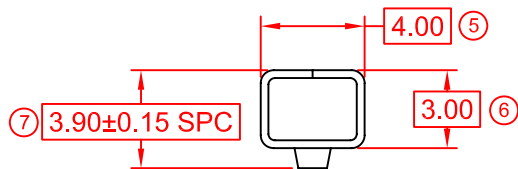

SECTION C-C

- REMARKS:
- a) PLATING THICKNESS MIN 40μ INCH
 - b) SUGGESTED WIRE INSULATION (O.D): 2.6MM
 - c) SUGGESTED WIRE RANGE: 0.88~0.39MM² (AWG16~18)
 - d) INSERT FORCE: MAX 0.80KG
 - e) TENSILE FORCE: MIN 0.20KG

GENERAL TOLERANCE UNLESS SPECIFIED:	PREPARE BY: KS YEW	Elamp Precision Industry(M) Sdn.Bhd.
X.XXX ±0.05 X.XX ±0.10 X.X ±0.20 X ±0.50	REVIEWED BY: CH ANG	
	APPROVED BY: CY CHUANG	ITEM NAME: LAMP SEAT TERMINAL
	EFFECTIVE DATE: 7/12/11	ITEM NO: 13900-2T
	SHEET OF: 1 / 1	DRAWING NO: EP-Q-163A
REVISION: 04	SCALE: FREE UNIT: MM	

REV.	DATE	AMENDMENT	ECR NO:
04	7/12/11	UPDATE TO NEW FORMAT	-