

# TERMINALS SPECIFICATION DRAWING

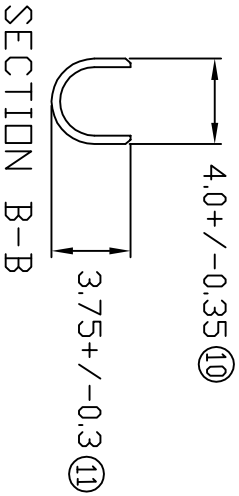
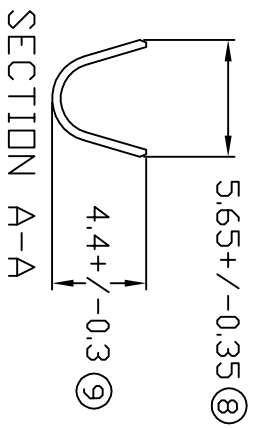
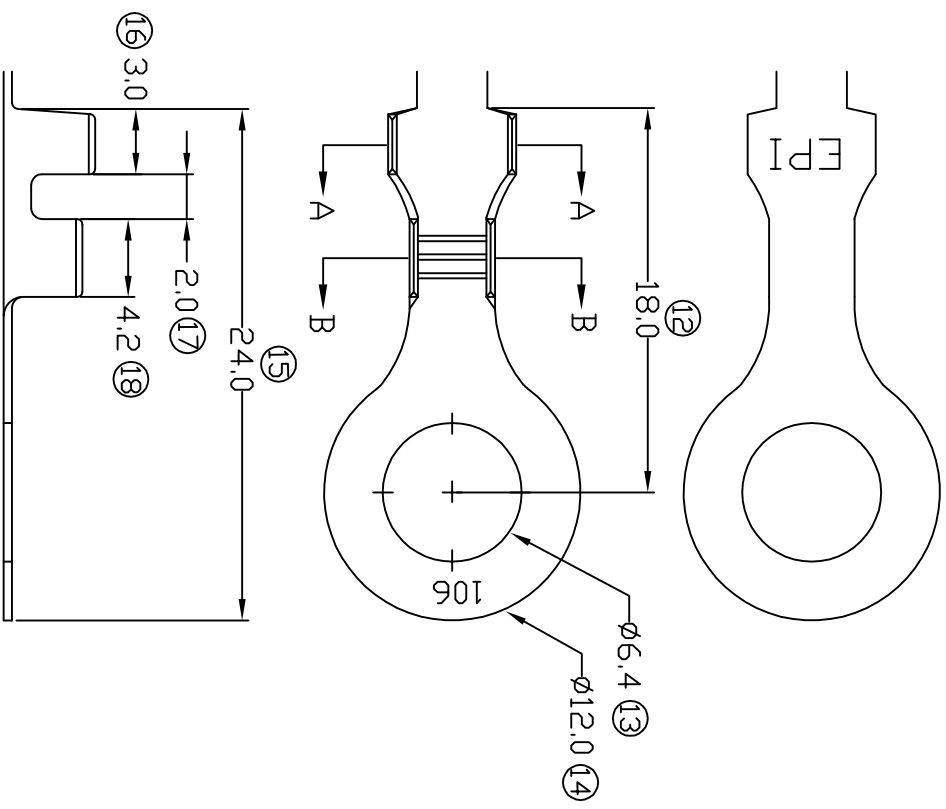

FOR REFERENCE ONLY

- 7) CRIMPING WIRE TENSILE FORCE IS BASE ON COPPER BREAK OFF INTENSITY.
- 6) TEMPERATURE RANGE: -40°C TO +120°C.
- 5) VOLTAGE-MAX [VOLTS] PER WIRE SPECIFICATION.
- 4) THICKNESS PLATING MORE THAN 40µ INCH.
- 3) PACKING QTY : 3500 PCS/REEL.
- 2) WIRE INSULATION (D.D) : 2.6MM.
- 1) APPLICABLE WIRE RANGE : 1.67-0.85MM<sup>2</sup>.

<b>MATERIAL:</b> t0.60 BRASS C2680		<b>PRE-TIN PLATED</b> NONE		141264-2T
<b>DIMENSIONS :</b> MM		<b>TREATMENT SELECTIVE</b>		PART NUMBER
<b>TOLERANCE UNLESS OTHERWISE SPECIFIED:</b> X.XXX +/-0.05 X.XX +/-0.10 X.X +/-0.20 X +/-0.50		<b>CHK: SC CHOO</b> Y.L APVD: CHUANG		<b>EPi</b> Terminals & Connectors Elamp Precision Industry(M) Sdn.Bhd.
<b>REVISION:</b> 01		<b>SCALE : FREE</b> DRAWING NO:		PART NAME: RING TONGUE TERMINALS
<b>SHEET OF :</b> 1 / 1		<b>EFFECTIVE DATE :</b> 11/7/07		APPLICABLE (1) TERMINALS (2) HOUSING (1) - (2) -
<b>DWN: KS YE W</b>		<b>A1464</b>		

**SPECIFICATION :**