

# TERMINALS SPECIFICATION DRAWING

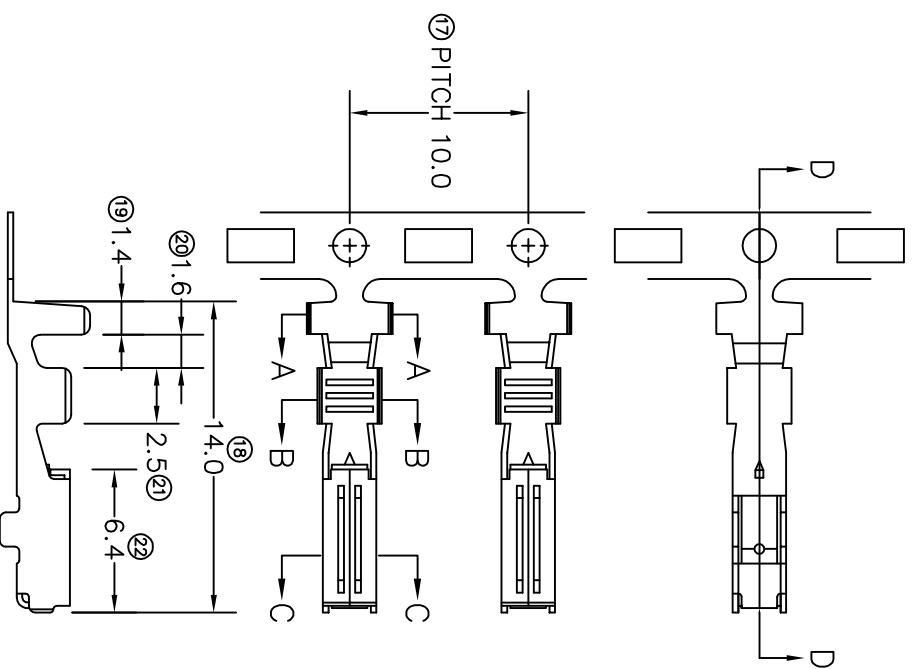

FOR REFERENCE ONLY

- 9) CRIMPING WIRE TENSILE FORCE IS BASE DN COPPER BREAK OFF INTENSITY,
- 8) TEMPERATURE RANGE -40°C TD +120°C,
- 7) VOLTAGE-MAX [VOLT(S)] PER WIRE SPECIFICATION,
- 6) TENSILE FORCE : MIN 0.35KG,
- 5) INSERT FORCE : MAX 0.65KG,
- 4) THICKNESS PLATING MORE THAN 40µ INCH,
- 3) PACKING QTY : 4500 PCS/REEL,
- 2) WIRE INSULATION (D.D) : 2.4MM,
- 1) APPLICABLE WIRE RANGE : 0.99-0.44MM<sup>2</sup>,

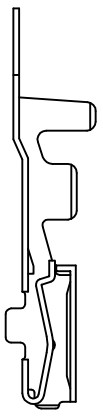

SECTION D-D

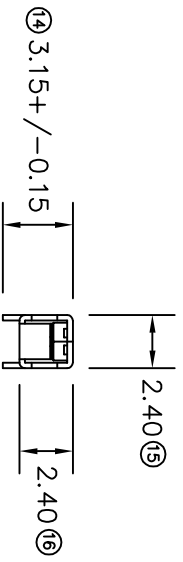

SECTION C-C

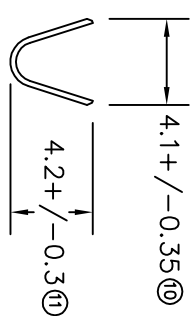

SECTION A-A

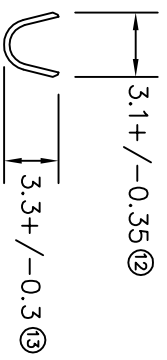

SECTION B-B

MATERIAL: TO.25 PHOSPHOR BRONZE C5191		PRE-TIN PLATED TREATMENT SELECTIVE		170602KH-2T PART NUMBER	
DIMENSIONS : MM		DWN: KS YE W		PART NAME: 060 SERIES FEMALE TERMINALS	
TOLERANCE UNLESS OTHERWISE SPECIFIED:		CHK: SC CHOO		Eiamp Precision Industry(M) Sdn.Bhd.	
REVISION: 04		APVD: CHUANG		(1) TAB to.8 X W1.7 (2) FV-JC-20F, FV-JC-10F	
X:XXX +/-0.05 X:XX +/-0.10 X:X +/-0.20 X +/-0.50		SCALE : FREE DRAWING NO:		A1230	
SHEET OF : 1 / 1		EFFECTIVE DATE : 17/7/07		A1230	

SPECIFICATION :