

# TERMINALS SPECIFICATION DRAWING

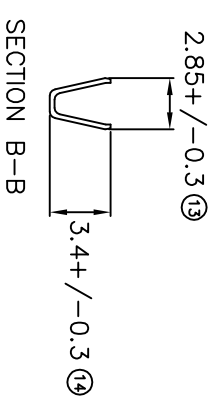
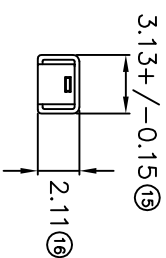
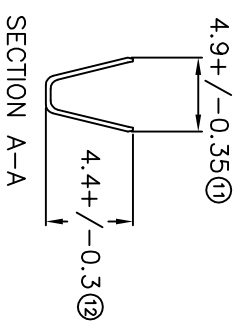
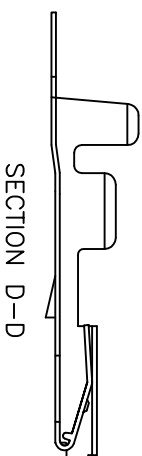
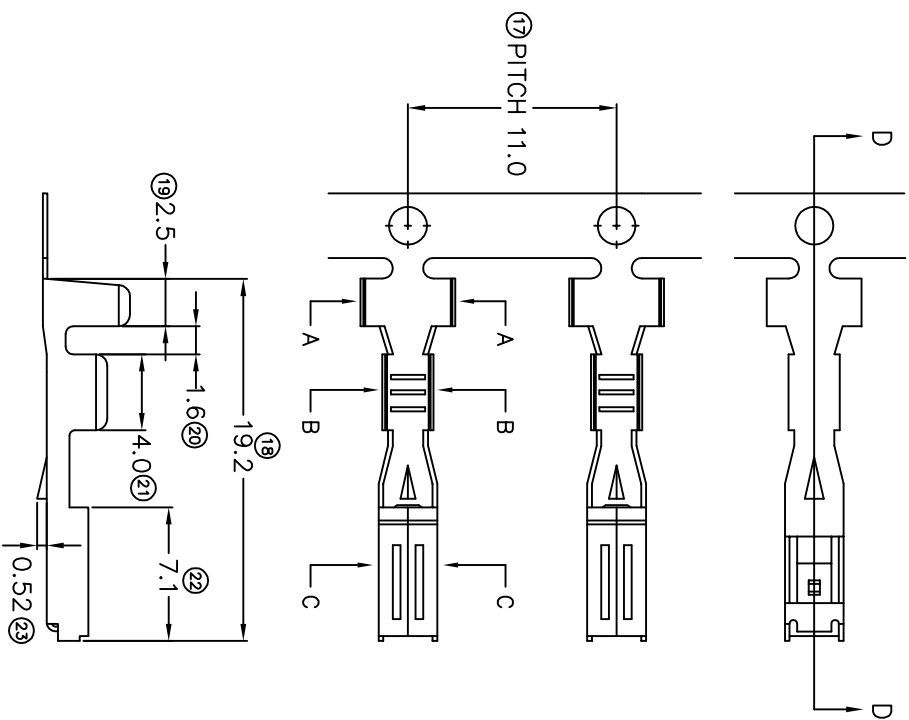

FOR REFERENCE ONLY

- 10) CRIMPING WIRE TENSILE FORCE IS BASE ON COPPER BREAK OFF INTENSITY.
- 9) TEMPERATURE RANGE -40°C TO +120°C.
- 8) VOLTAGE-MAX [VOLTS] PER WIRE SPECIFICATION.
- 7) MATCHING WITH TAB t0.6 X W/2.2.
- 6) TENSILE FORCE : MIN 0.20KG.
- 5) INSERT FORCE : MAX 0.50KG.
- 4) THICKNESS PLATING MORE THAN 40µ INCH.
- 3) PACKING QTY : 4000 PCS/REEL.
- 2) WIRE INSULATION (O.D) : 2.6MM.
- 1) APPLICABLE WIRE RANGE : 0.99-0.44MM<sup>2</sup>.

<b>MATERIAL:</b> +0.25 BRASS C2680		<b>PRE-TIN PLATED</b> TREATMENT SELECTIVE		170903H-2T PART NUMBER	
<b>DIMENSIONS :</b> MM TOLERANCE UNLESS OTHERWISE SPECIFIED:		DWN: KS YE'W CHK: SC CHOO Y.L APVD: CHUANG		<b>EPI</b> Terminals & Connectors Elamp Precision Industry(M) Sdn.Bhd. PART NAME: 090 SERIES FEMALE TERMINALS APPLICABLE (1) TERMINALS (2) HOUSING (1) TAB t0.60 X W2.2 (2) 090 SERIES HOUSING	
X.XXX +/-0.05 X.XX +/-0.10 X.X +/-0.20 X +/-0.50		SCALE : FREE DRAWING NO:			
<b>EFFECTIVE DATE :</b> 11/7/07		A1357			
<b>REVISION:</b> 03		SHEET OF : 1 / 1			

**SPECIFICATION :**