

# TERMINALS SPECIFICATION DRAWING

UNCONTROLLED COPY

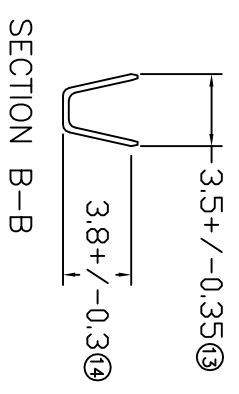
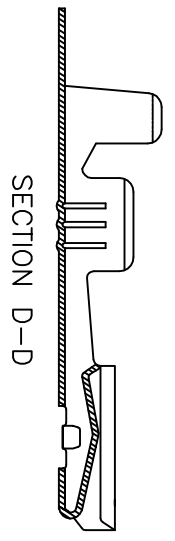
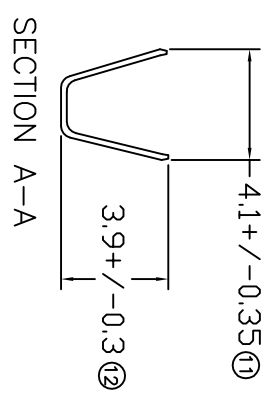
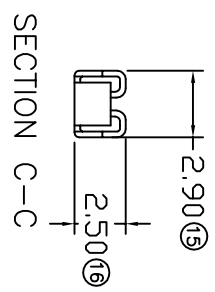
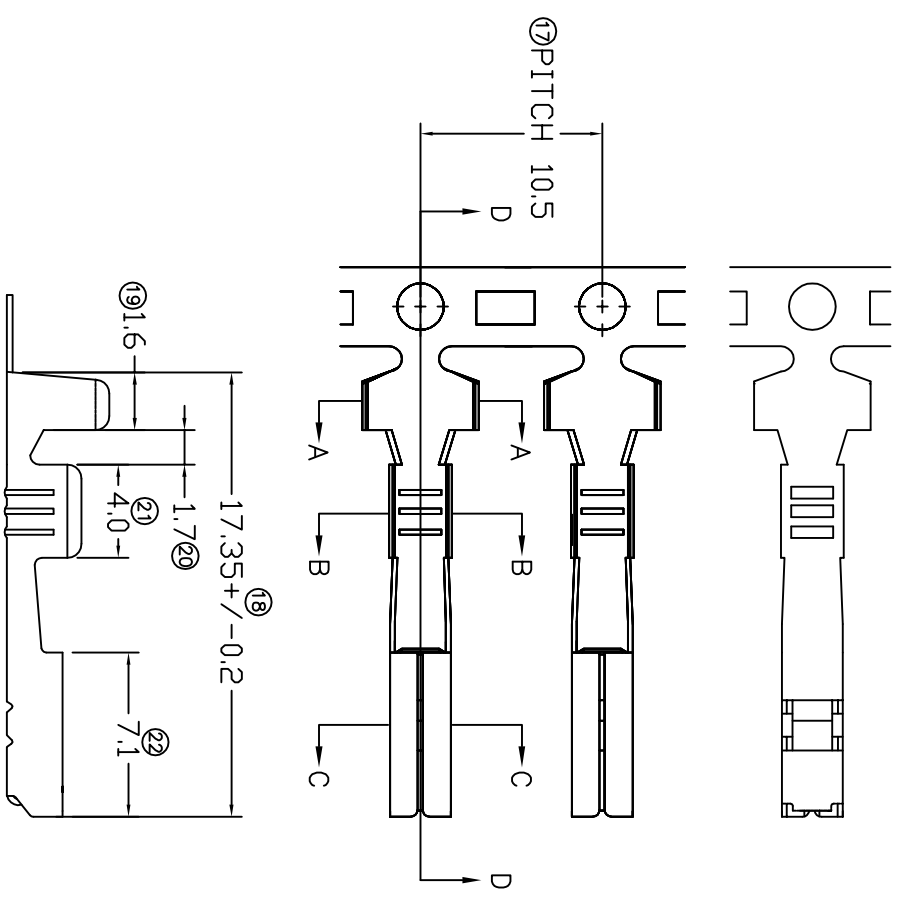

- 10) CRIMPING WIRE TENSILE FORCE IS BASE ON COPPER BREAK OFF INTENSITY.
- 9) TEMPERATURE RANGE -40°C TO +120°C.
- 8) VOLTAGE-MAX [VOLTS] PER WIRE SPECIFICATION.
- 7) MATCHING WITH TAB t0.6 X W2.2.
- 6) TENSILE FORCE : MIN 0.25KG.
- 5) INSERT FORCE : MAX 0.60KG.
- 4) THICKNESS PLATING MORE THAN 40µ INCH.
- 3) PACKING QTY : 5000 PCS/REEL.
- 2) WIRE INSULATION (O.D) : 2.3MM.
- 1) APPLICABLE WIRE RANGE : 1.31-0.58MM².

SPECIFICATION :

**FOR REFERENCE ONLY**

MATERIAL: 10.25 BRASS C2680		PRE-TIN PLATED TREATMENT SELECTIVE		17090M-2T PART NUMBER	
DIMENSIONS : MM TOLERANCE UNLESS OTHERWISE SPECIFIED:		DWN: KS YEW CHK: CHUANG Y.L APVD: CHUANG		PART NAME: Elamp Precision Industry(M) Sdn.Bhd. 090 SERIES FEMALE TERMINALS	
X.XXX +/-0.05 X.XX +/-0.10 X.X +/-0.20 X +/-0.50		SCALE : FREE DRAWING NO:		APPLICABLE (1) TERMINALS (2) HOUSING (1) 27090S/M/H (2) 090 SERIES	
EFFECTIVE DATE : 25/7/08		A1232			
REVISION: 05		SHEET OF : 1 / 1			
APPLICABLE (2) FV-JC-10F CHANGE TO 090 SERIES AMENDMENT					
DATE 25/7/08					
REV.					