

# TERMINALS SPECIFICATION DRAWING

UNCONTROLLED COPY

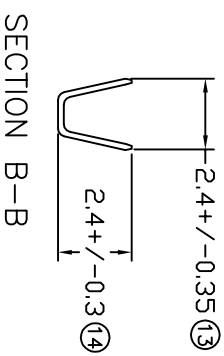
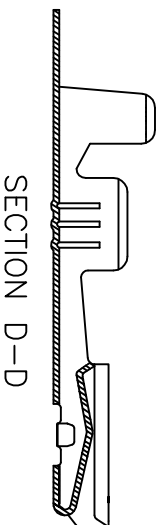
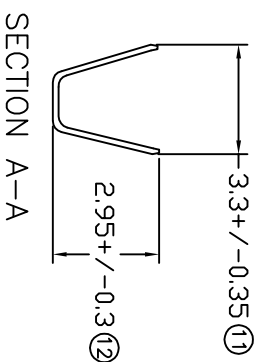
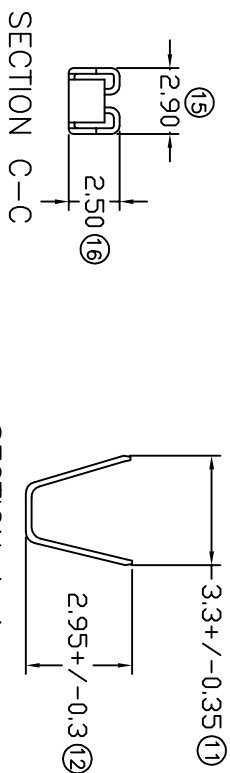
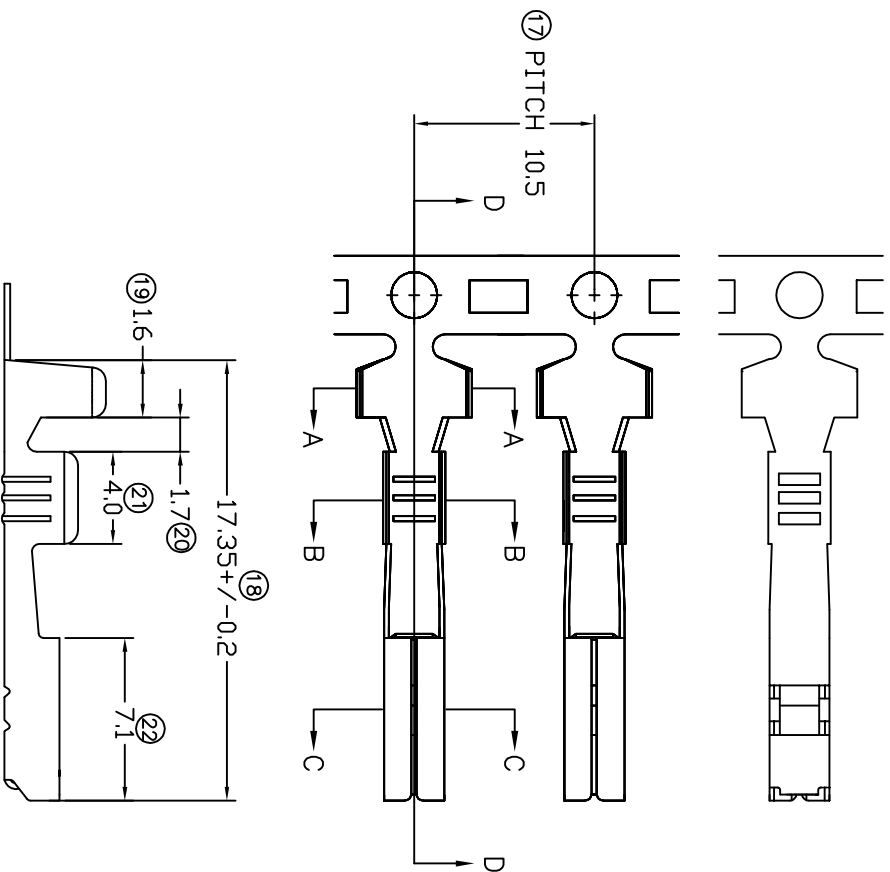

- 10) CRIMPING WIRE TENSILE FORCE IS BASE ON COPPER BREAK OFF INTENSITY.
- 9) TEMPERATURE RANGE -40°C TO +120°C.
- 8) VOLTAGE-MAX [VOLTS] PER WIRE SPECIFICATION.
- 7) MATCHING WITH TAB t0.6 X W2.2.
- 6) TENSILE FORCE : MIN 0.25KG.
- 5) INSERT FORCE : MAX 0.60KG.
- 4) THICKNESS PLATING MORE THAN 40μ INCH.
- 3) PACKING QTY : 6000 PCS/REEL.
- 2) WIRE INSULATION (O.D) : 1.8MM.
- 1) APPLICABLE WIRE RANGE : 0.46-0.21MM<sup>2</sup>.

SPECIFICATION :

**FOR REFERENCE ONLY**

REVISION:

05



SHEET OF :

1 / 1

MATERIAL:  
to.25 BRASS  
C2680

DIMENSIONS : MM  
TOLERANCE UNLESS  
OTHERWISE SPECIFIED:

X.XXX	+/-0.05
X.XX	+/-0.10
X.X	+/-0.20
X	+/-0.50

EFFECTIVE DATE :  
25/7/08

PRE TIN PLATED 17090S-2T

TREATMENT SELECTIVE PART NUMBER

**EPI** Terminals & Connectors  
Elamp Precision Industry(M) Sdn.Bhd.

DWN: KS YEW  
CHK: CHUANG  
APVD: CHUANG

PART NAME:  
090 SERIES FEMALE TERMINALS  
APPLICABLE (1) TERMINALS (2) HOUSING

SCALE : FREE  
DRAWING NO: A1233  
(1) 27090S/M/H  
(2) 090 SERIES

REV.	DATE	APPLICABLE (2) FV-JC-10F CHANGE TO 090 SERIES	AMENDMENT