

# SPECIFICATION DRAWING

MASTER COPY

| ITEM NO   | MATERIAL            | TREATMENT   | QTY/REEL  | REEL/CARTON | MATCHING PART(S)         |
|-----------|---------------------|-------------|-----------|-------------|--------------------------|
| 17110EH-1 | t0.25 BRASS (C2680) | NONE        | 10000 PCS | 4           | TERMINAL-TAB t0.5 X W2.8 |
| 17110EH-2 | t0.25 BRASS (C2680) | TIN PLATING | 10000 PCS | 4           | HOUSING-N/A              |

| SYMBOL | DESCRIPTION                                    |
|--------|--|
| ○      | DIMENSION INSPECTED DURING SETUP AND OUTGOING. |
| □      | DIMENSION INSPECTED HOURLY.                    |
| SPC    | STATISTICALLY CONTROLLED DIMENSION.            |
| △      | JIG USED DURING INSPECTION.                    |

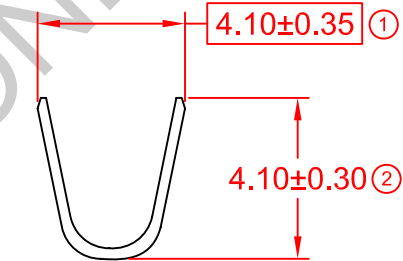
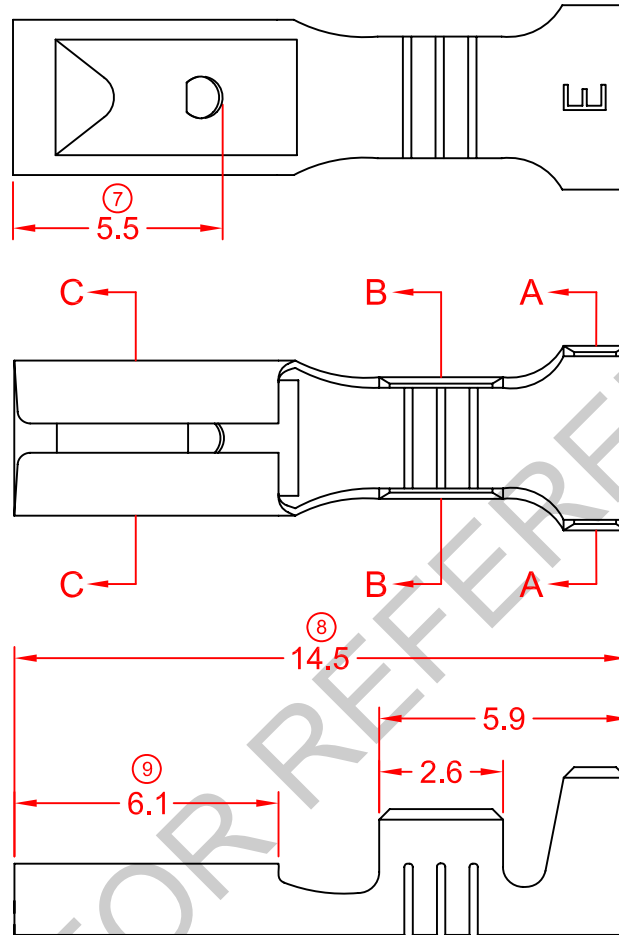
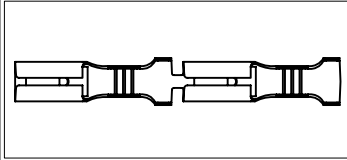

SECTION A-A

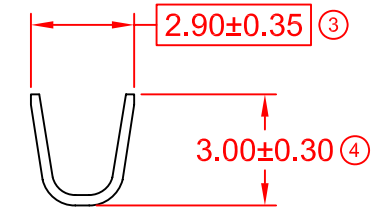

SECTION B-B

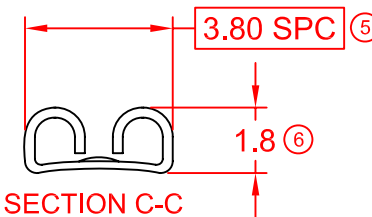

SECTION C-C

**REMARKS:**

- a) PLATING THICKNESS MIN 40μ INCH
- b) SUGGESTED WIRE INSULATION (O.D): 2.5MM
- c) SUGGESTED WIRE RANGE: 0.77~0.34MM<sup>2</sup> (AWG16~20)
- d) INSERT FORCE: MAX 3.00KG
- e) TENSILE FORCE: MIN 2.20KG

|      |        |                      |         |                    |   |                           |                                       |
|------|--------|----------------------|---------|--------------------|---|---------------------------|---------------------------------------|
|      |        |                      |         | REVISION:<br>05    | GENERAL TOLERANCE<br>UNLESS SPECIFIED:<br>X.XXX ±0.05<br>X.XX ±0.10<br>X.X ±0.20<br>X ±0.50 | PREPARE BY:<br>KS YEW     | Elamp Precision Industry(M) Sdn.Bhd.  |
|      |        |                      |         | ⊕                  |   | REVIEWED BY:<br>CH ANG    |                                       |
|      |        |                      |         |                    |   | APPROVED BY:<br>CY CHUANG | ITEM NAME: 110 SERIES FEMALE TERMINAL |
| 05   | 1/2/12 | UPDATE TO NEW FORMAT | -       | SHEET OF:<br>1 / 1 | EFFECTIVE DATE:<br>1/2/12   | SCALE : FREE<br>UNIT : MM | ITEM NO: 17110EH-1, 2                 |
| REV. | DATE   | AMENDMENT            | ECR NO: |                    |   |                           | DRAWING NO: EP-Q-142A                 |