

SPECIFICATION DRAWING

MASTER COPY

ITEM NO	MATERIAL	TREATMENT	QTY/REEL	REEL/CARTON	MATCHING PART(S)
17150PM(0.8)-1	t0.3 PBR (C5191)	NONE	10000 PCS	4	TERMINAL-27118M HOUSING-N/A

SYMBOL	DESCRIPTION
○	DIMENSION INSPECTED DURING SETUP AND OUTGOING.
□	DIMENSION INSPECTED HOURLY.
SPC	STATISTICALLY CONTROLLED DIMENSION.
△	JIG USED DURING INSPECTION.

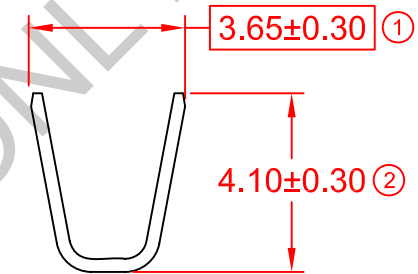
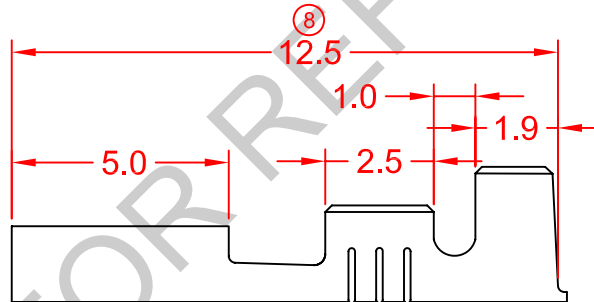
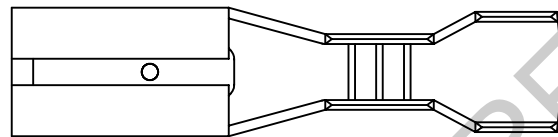
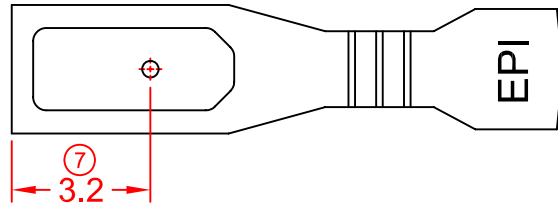
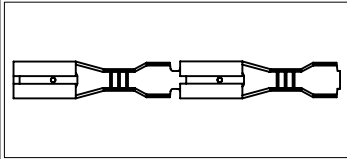

SECTION A-A

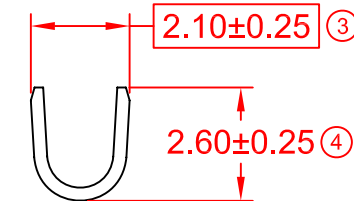

SECTION B-B

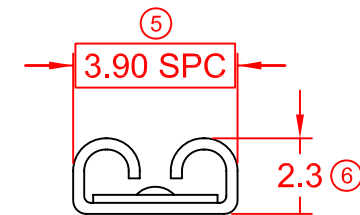

SECTION C-C

REMARKS:

- a) PLATING THICKNESS MIN 40μ INCH
- b) SUGGESTED WIRE INSULATION (O.D): 2.3MM
- c) SUGGESTED WIRE RANGE: 0.54~0.24MM² (AWG18-22)
- d) INSERT FORCE: MAX 3.00KG
- e) TENSILE FORCE: MIN 1.50KG

				REVISION:	GENERAL TOLERANCE UNLESS SPECIFIED:	PREPARE BY:	EPI Elamp Precision Industry(M) Sdn.Bhd.
				05	X.XXX ±0.05 X.XX ±0.10 X.X ±0.20 X ±0.50	KS YEW	
				⊕		REVIEWED BY:	ITEM NAME: 150 SERIES FEMALE TERMINAL
				SHEET OF:		CH ANG	
05	12/1/12	UPDATE TO NEW FORMAT	-	1 / 1	EFFECTIVE DATE:	APPROVED BY:	ITEM NO: 17150PM(0.8)-1
REV.	DATE	AMENDMENT	ECR NO:		12/1/12	CY CHUANG	DRAWING NO: EP-Q-309A
						SCALE : FREE UNIT : MM	