

TERMINALS SPECIFICATION DRAWING

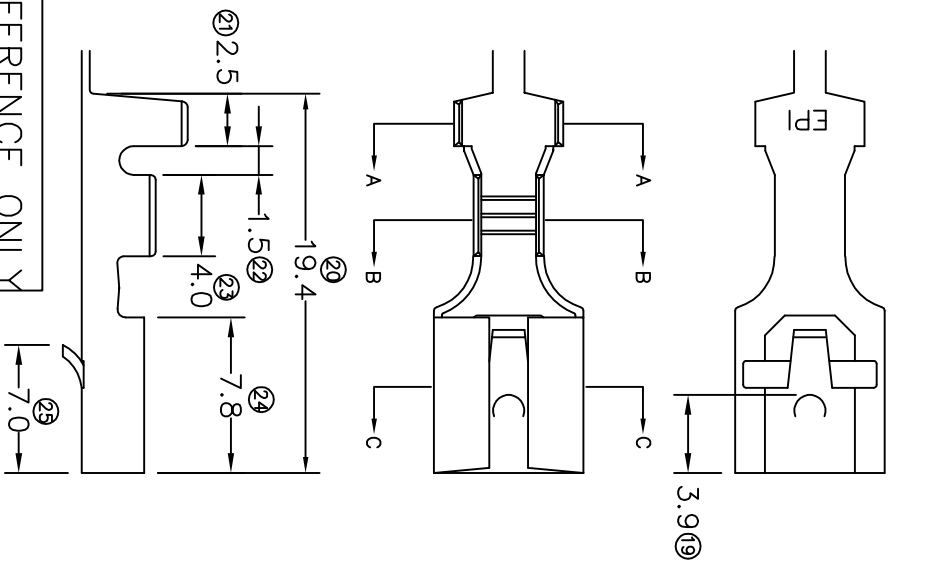

FOR REFERENCE ONLY

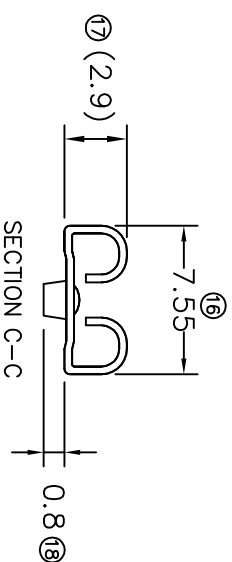
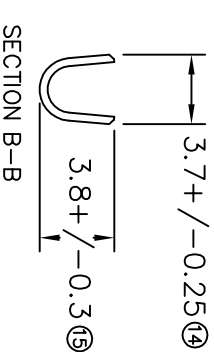
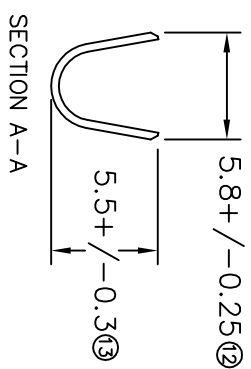

- 1) CRIMPING WIRE TENSILE FORCE IS BASE ON COPPER BREAK OFF INTENSITY.
- 10) TEMPERATURE RANGE: -40°C TO +120°C.
- 9) VOLTAGE-MAX (VOLTS) PER WIRE SPECIFICATION.
- 8) 17 FDR REFERENCE ONLY.
- 7) MATCHING WITH TAB t0.8 X W6.3.
- 6) TENSILE FORCE: MIN 4.00KG.
- 5) INSERT FORCE: MAX 3.20KG.
- 4) THICKNESS PLATING MORE THAN 40μ INCH.
- 3) PACKING QTY: 5000 PCS/REEL.
- 2) WIRE INSULATION (O.D.): 3.2MM.
- 1) APPLICABLE WIRE RANGE: 1.76-0.90MM².

SPECIFICATION:

	REVISION: 01		SHEET OF : 1 1				
MATERIAL: T0.40 BRASS C2680		DIMENSIONS : MM		TIN PLATING		172504-2	
TOLERANCE UNLESS OTHERWISE SPECIFIED: X:XXX +/-0.05 X:XX +/-0.10 X:X +/-0.20 X +/-0.50		DWN: KS YEW		NONE		172504-1	
EFFECTIVE DATE : 17/7/07		CHK: SC CHOO		TREATMENT SELECTIVE		PART NUMBER	
		APVD: CHUANG		PART NAME:		EPI Terminals & Connectors Elamp Precision Industry(M) Sdn.Bhd.	
		SCALE : FREE		PART NAME:		250 SERIES FEMALE TERMINALS	
		DRAWING NO: A1454		PART NAME:		250 SERIES FEMALE TERMINALS	
				APPLICABLE (1) TERMINALS (2) HOUSING			
				(1) TAB t0.80 X W6.3			
				(2) 250 TYPE RELAY			