

TERMINALS SPECIFICATION DRAWING

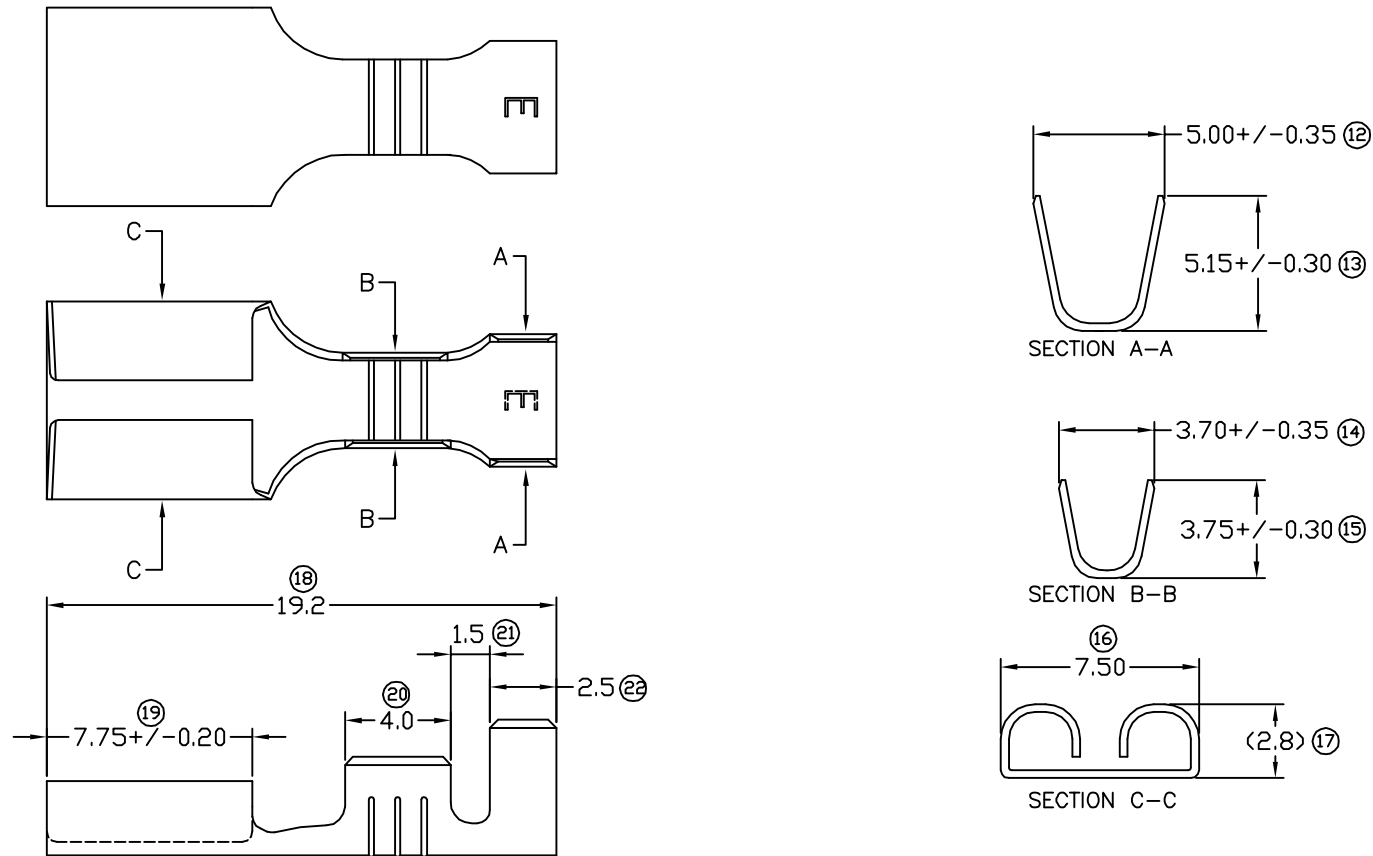

- 11) CRIMPING WIRE TENSILE FORCE IS BASE ON COPPER BREAK OFF INTENSITY.
- 10) TEMPERATURE RANGE -40°C TO $+120^{\circ}\text{C}$.
- 9) VOLTAGE-MAX [VOLTS] PER WIRE SPECIFICATION.
- 8) (17) FOR REFERENCE ONLY.
- 7) MATCHING WITH TAB t0.8 X W6.0.
- 6) TENSILE FORCE : MIN 0.50KG.
- 5) INSERT FORCE : MAX 1.80KG.
- 4) THICKNESS PLATING MORE THAN 40μ INCH.
- 3) PACKING QTY : 5000 PCS/REEL.
- 2) WIRE INSULATION (O.D) : 2.9MM.
- 1) APPLICABLE WIRE RANGE : 1.19-0.53MM².

FOR REFERENCE ONLY

SPECIFICATION :

		ITEM NO: ADD 172505M-2T, 5) INSERT FORCE: MAX 2.40KG CHANGE TO MAX 1.80KG. 6) TENSILE FORCE: MIN 0.60KG CHANGE TO MIN 0.50KG.
REV.	DATE	AMENDMENT

REVISION: 06
SHEET OF : 1 / 1

MATERIAL: t0.30 BRASS C2680	PRE-TIN PLATED		172505M-2T
	TIN PLATING		172505M-2
	NONE		172505M-1
	TREATMENT SELECTIVE		PART NUMBER
DIMENSIONS : MM TOLERANCE UNLESS OTHERWISE SPECIFIED: X.XXX +/-0.05 X.XX +/-0.10 X.X +/-0.20 X +/-0.50	DWN: KS YEW CHK: C.Y CHUANG APVD: Y.L CHUANG SCALE : FREE DRAWING NO: A1325	EPI Terminals & Connectors Elamp Precision Industry(M) Sdn.Bhd. PART NAME: 250 SERIES FEMALE TERMINALS APPLICABLE (1) TERMINALS (2) HOUSING (1) 272505 S/M/H (2) CN2FSL SERIES	
EFFECTIVE DATE : 18/3/09			