

SPECIFICATION DRAWING

MASTER COPY

ITEM NO	MATERIAL	TREATMENT	QTY/REEL	REEL/CARTON	MATCHING PART(S)
17250M-1	t0.4 BRASS (C2680)	NONE	5000 PCS	4	TERMINAL-TAB t0.8XW6.30
17250M-2	t0.4 BRASS (C2680)	TIN-PLATING	5000 PCS	4	HOUSING-NONE
17250M-2T	t0.4 BRASS (C2680)	PRE-TIN PLATED	5000 PCS	4	

SYMBOL	DESCRIPTION
○	DIMENSION INSPECTED DURING SETUP AND OUTGOING.
□	DIMENSION INSPECTED HOURLY.
SPC	STATISTICALLY CONTROLLED DIMENSION.
△	JIG USED DURING INSPECTION.

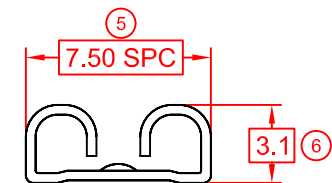
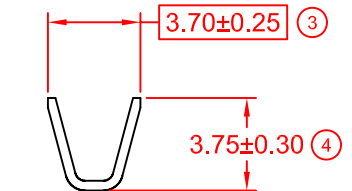
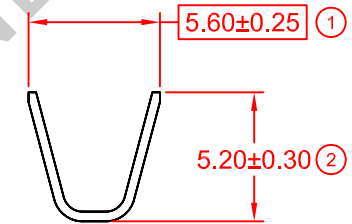
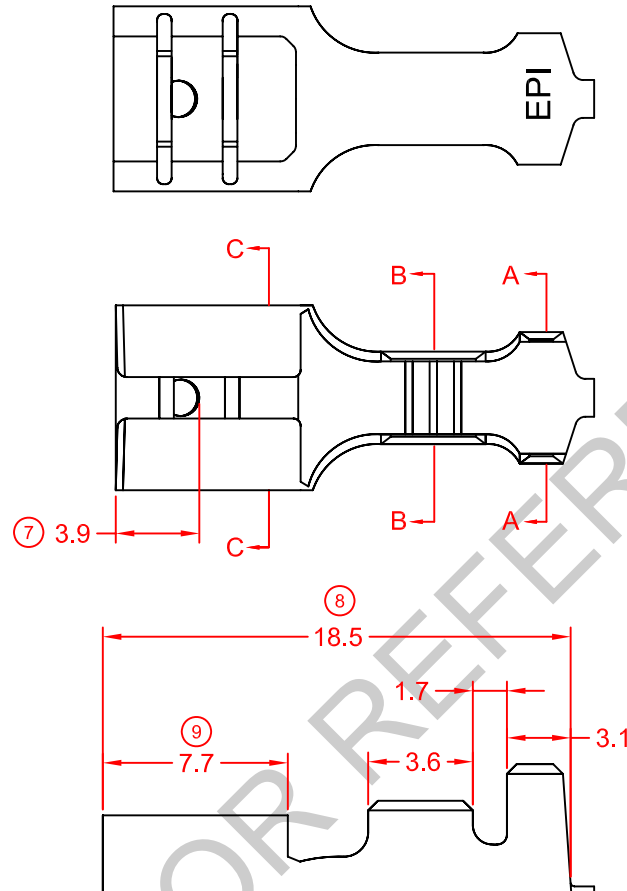
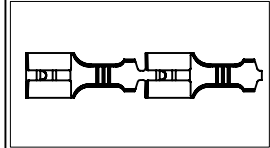

REMARKS:

- a) PLATING THICKNESS MIN 40μ INCH
- b) SUGGESTED WIRE INSULATION (O.D): 3.1MM
- c) SUGGESTED WIRE RANGE: 1.58-0.81MM² (AWG14~18)
- d) INSERT FORCE: MAX 4.00KG
- e) TENSILE FORCE: MIN 3.50KG

				REVISION: 06	GENERAL TOLERANCE UNLESS SPECIFIED: X.XXX ±0.05 X.XX ±0.10 X.X ±0.20 X ±0.50	PREPARE BY: KS YEW	Elamp Precision Industry(M) Sdn.Bhd.
						REVIEWED BY: CH ANG	
						APPROVED BY: CY CHUANG	ITEM NO: 17250M-1, 2, 2T
06	12/8/11	UPDATE TO NEW FORMAT	-	SHEET OF: 1 / 1	EFFECTIVE DATE: 12/8/11	SCALE: FREE	DRAWING NO: EP-Q-337A
REV.	DATE	AMENDMENT	ECR NO:			UNIT: MM	