

# TERMINALS SPECIFICATION DRAWING

UNCONTROLLED COPY

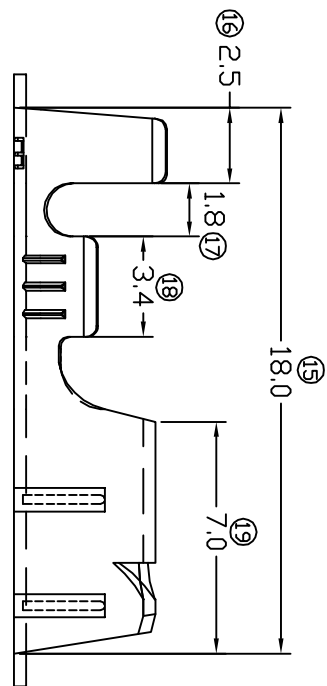
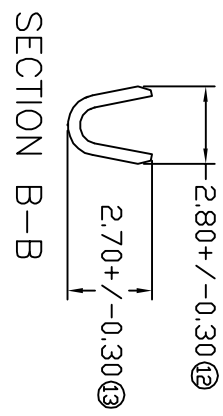
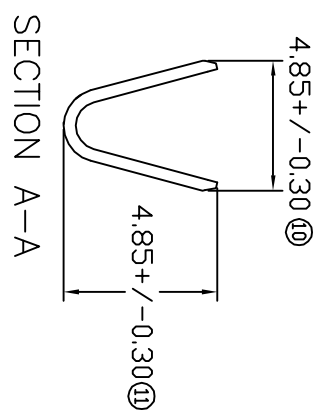
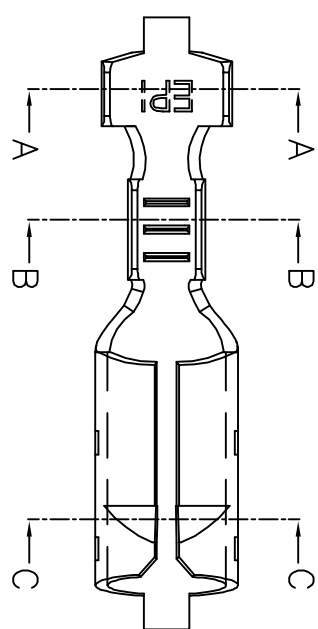
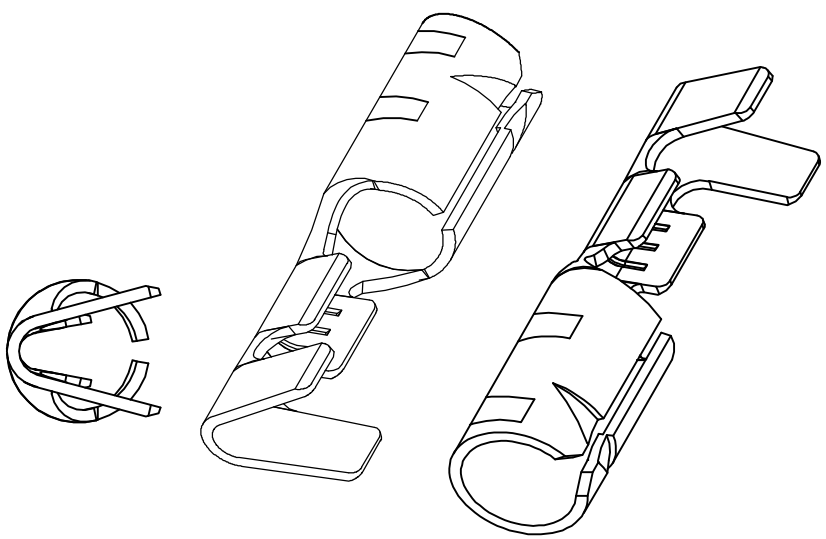

SECTION C-C

- 9) CRIMPING WIRE TENSILE FORCE IS BASE ON COPPER BREAK OFF INTENSITY.
- 8) TEMPERATURE RANGE -40°C TO +120°C.
- 7) VOLTAGE-MAX [VOLTS] PER WIRE SPECIFICATION.
- 6) TENSILE FORCE : MIN 2.00KG.
- 5) INSERT FORCE : MAX 4.00KG.
- 4) THICKNESS PLATING MORE THAN 40µ INCH.
- 3) PACKING QTY : 8000 PCS/REEL.
- 2) WIRE INSULATION (O.D) : 2.8MM.
- 1) APPLICABLE WIRE RANGE : 0.62-0.28MM².

SPECIFICATION :

**FOR REFERENCE ONLY**

REVISION:

02



SHEET OF :  
1 / 1

02	13/11/08	CHANGE DIM FR (17) 1.75 TO 1.8, FR (19) 8.00 TO 7.0	
01	22/05/08	CHANGE THICKNESS FROM 0.40 TO 0.35	
00	24/03/07	NEW RELEASE	
REV.	DATE		AMENDMENT

MATERIAL: t0.35 BRASS C2680	TIN PLATING 18051AS-2
DIMENSIONS : MM TOLERANCE UNLESS OTHERWISE SPECIFIED: X.XXX +/-0.05 X.XX +/-0.10 X.X +/-0.20 X +/-0.50	TREATMENT SELECTIVE 18051AS-1
DWN: KS YEW CHK: CHUANG	PART NUMBER 18051AS-1
APVD: CHUANG SCALE : FREE DRAWING NO: A1523	PART NAME: Ø5.00MM BULLET TERMINALS APPLICABLE (1) TERMINALS (2) HOUSING (1) 28051 (2) -
EFFECTIVE DATE : 13/11/08	EPI Terminals & Connectors Elamp Precision Industry(M) Sdn.Bhd.