

# TERMINALS SPECIFICATION DRAWING

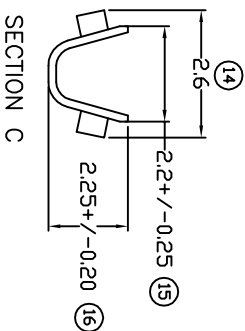
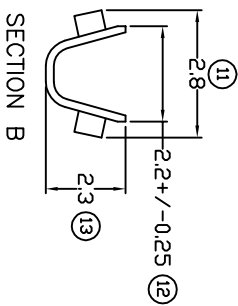
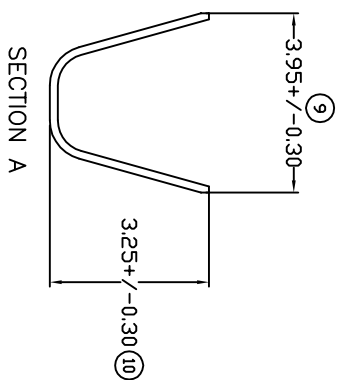
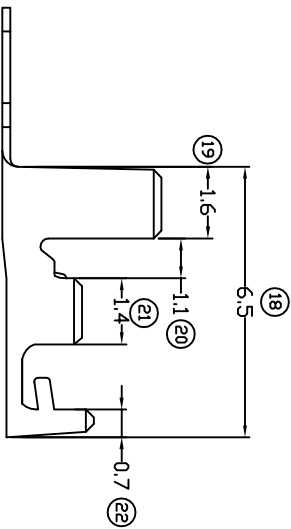
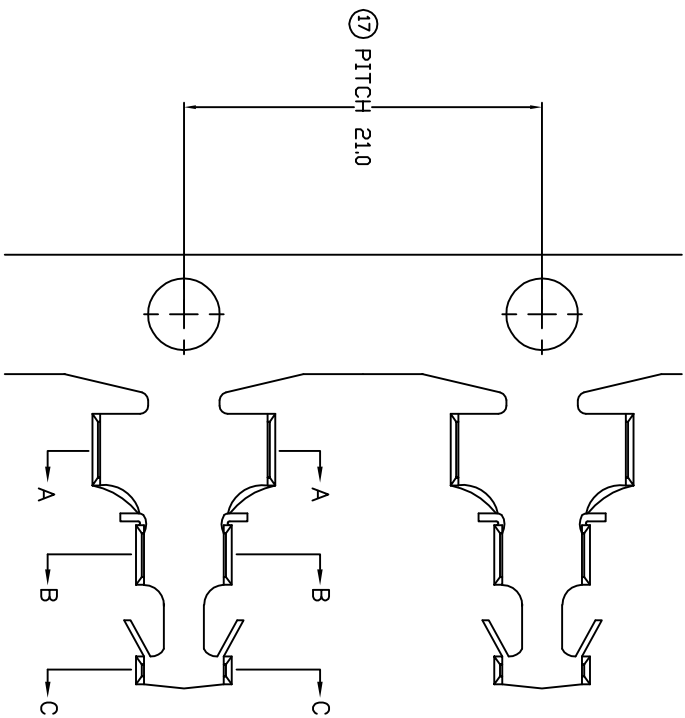

## FOR REFERENCE ONLY

- 8) CRIMPING WIRE TENSILE FORCE IS BASE ON COPPER BREAK OFF INTENSITY.
- 7) TEMPERATURE RANGE -40°C TO +120°C.
- 6) VOLTAGE-MAX (VOLTS) PER WIRE SPECIFICATION.
- 5) FDR PC BOARD Ø1.85.
- 4) THICKNESS PLATING MORE THAN 40µ INCH.
- 3) PACKING QTY : 10000 PCS/REEL.
- 2) WIRE INSULATION (C.D.) : 2.0MM.
- 1) APPLICABLE WIRE RANGE : 0.45-0.20MM<sup>2</sup>.

### SPECIFICATION :

<b>REVISION:</b> 00		<b>MATERIAL:</b> t0.20 BRASS C2680			
		<b>TOLERANCE UNLESS OTHERWISE SPECIFIED:</b>	<b>TREATMENT SELECTIVE</b>	<b>TIN PLATED</b>	<b>22019-2</b>
<b>SHEET OF :</b> 1 / 1	<b>EFFECTIVE DATE :</b> 20/9/07	<b>DIMENSIONS : MM</b>	<b>DWN: KS YEW</b>	<b>TREATMENT SELECTIVE</b>	<b>PART NUMBER</b>
		<b>TOLERANCE UNLESS OTHERWISE SPECIFIED:</b>	<b>CHK: HY LIM</b>	<b>APVD: CHUANG</b>	<b>PART NAME:</b>
		X.XXX +/-0.05			<b>BOARD-IN CRIMP STYLE TERMINALS</b>
		X.XX +/-0.10			<b>Elamp Precision Industry(M) Sdn.Bhd.</b>
		X.X +/-0.20			
		X +/-0.50			
				<b>SCALE : FREE</b>	<b>APPLICABLE (1) TERMINALS (2) HOUSING</b>
				<b>DRAWING NO:</b>	
				<b>A1516</b>	
					<b>(1) -</b>
					<b>(2) -</b>