

# TERMINALS SPECIFICATION DRAWING

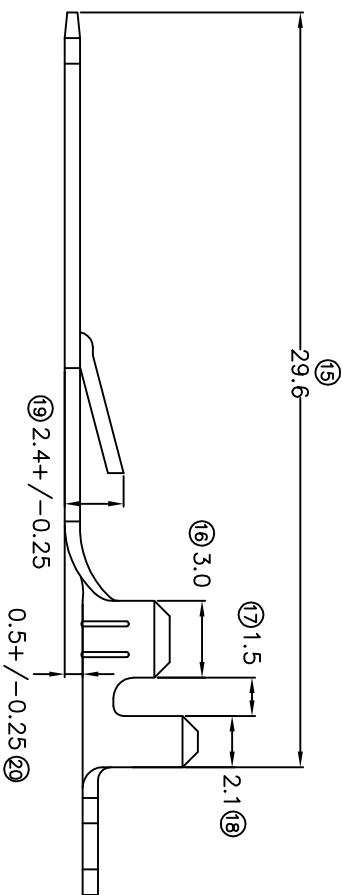
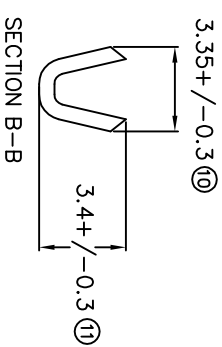
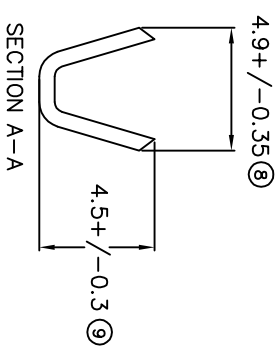
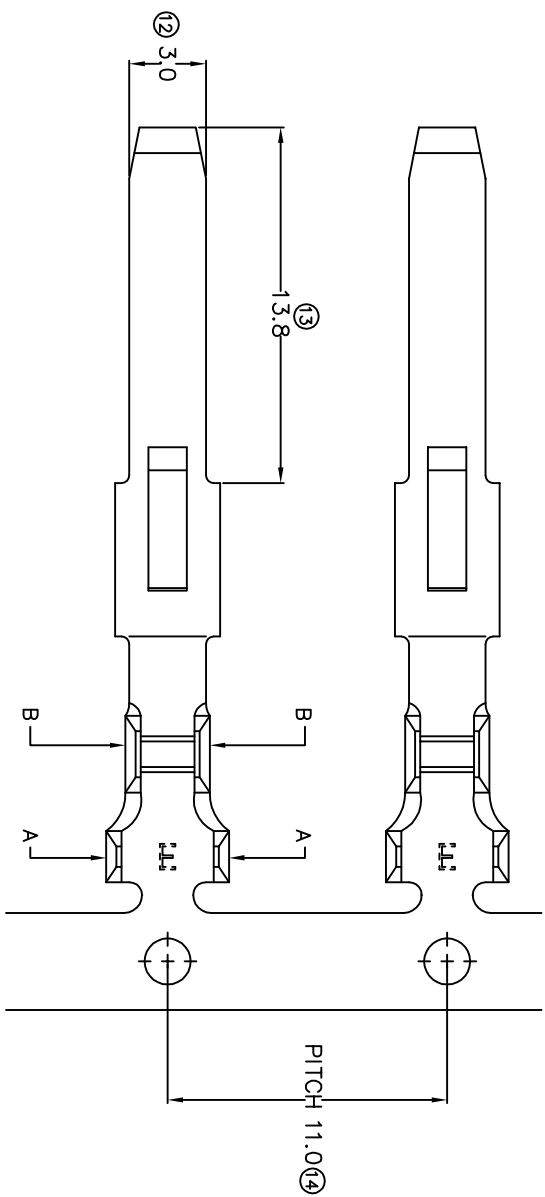

FOR REFERENCE ONLY

- 7) CRIMPING WIRE TENSILE FORCE IS BASE ON COPPER BREAK OFF INTENSITY,
- 6) TEMPERATURE RANGE -40°C TO +120°C,
- 5) VOLTAGE-MAX (VOLTS) PER WIRE SPECIFICATION
- 4) THICKNESS PLATING MORE THAN 40μ INCH,
- 3) PACKING QTY : 3000 PCS/REEL,
- 2) WIRE INSULATION (D.D) : 2.5MM,
- 1) APPLICABLE WIRE RANGE : 1.15-0.59MM² ,

SPECIFICATION :

MATERIAL: t0.60 BRASS C2680		PRE-TIN PLATED 26016-2T	
DIMENSIONS : MM		TIN PLATING 26016-2	
TOLERANCE UNLESS OTHERWISE SPECIFIED:		NONE 26016-1	
DWN: KS YE W		TREATMENT SELECTIVE PART NUMBER	
CHK: SC CHOO		<b>Terminis &amp; Connectors</b> Elamp Precision Industry(M) Sdn.Bhd.	
APVD: CHUANG			
SCALE : FREE		PART NAME: QUICK DISCONNECTABLE TAB	
DRAWING NO: A1385		APPLICABLE (1) TERMINALS (2) HOUSING	
EFFECTIVE DATE : 13/7/07		(1) 13900	
SHEET OF : 1 / 1		(2) CA016	

REVISION:

03



SHEET OF :

1 / 1