

# TERMINALS SPECIFICATION DRAWING

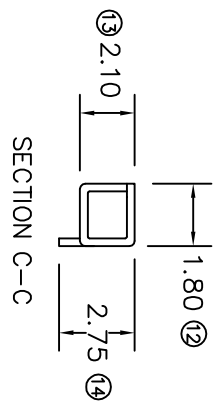
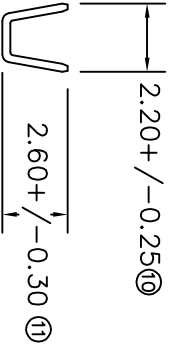
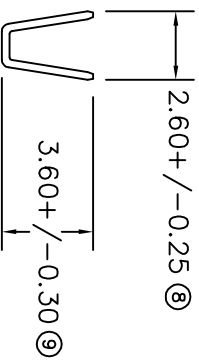
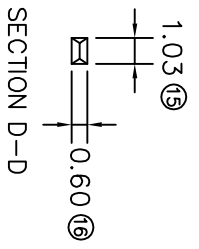
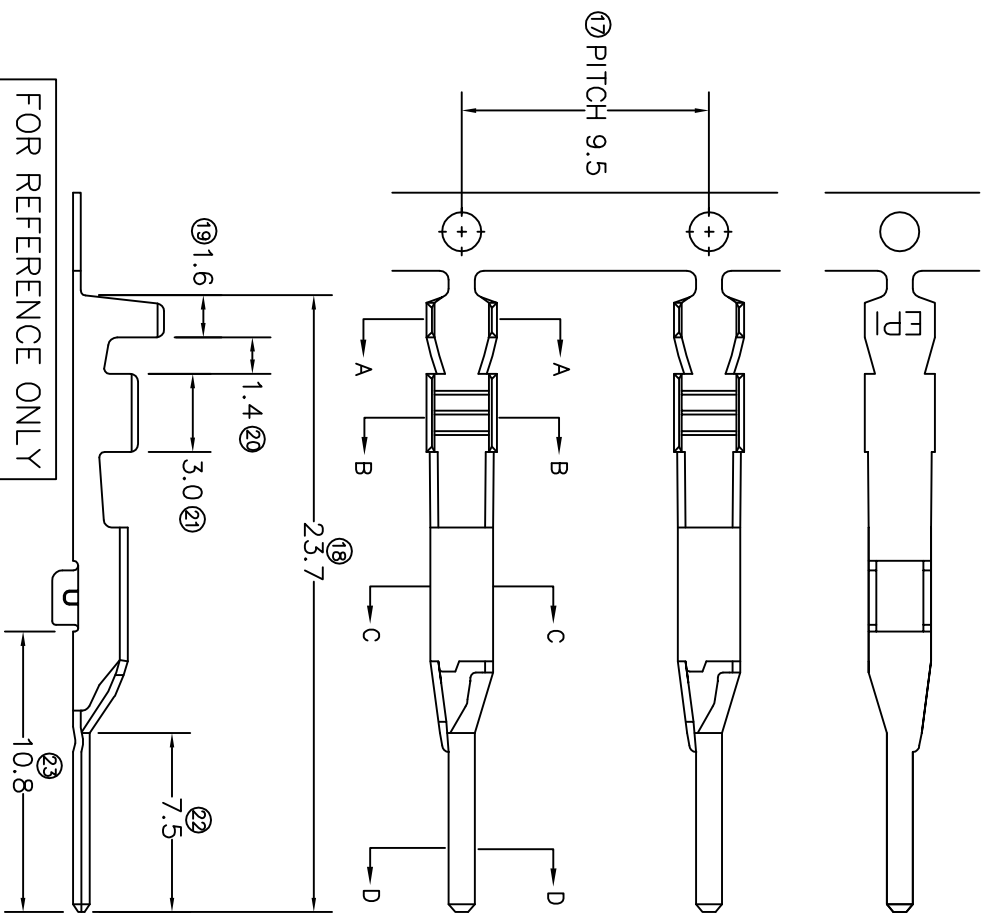

- 7) CRIMPING WIRE TENSILE FORCE IS BASE ON COPPER BREAK OFF INTENSITY.
- 6) TEMPERATURE RANGE -40°C TO +120°C.
- 5) VOL TAGE-MAX [VOLT(S)] PER WIRE SPECIFICATION.
- 4) THICKNESS PLATING MORE THAN 40μ INCH.
- 3) PACKING QTY : 5000 PCS/REEL.
- 2) WIRE INSULATION (O.D) : 1.9MM.
- 1) APPLICABLE WIRE RANGE : 0.56-0.25MM<sup>2</sup>.

SPECIFICATION :

MATERIAL:		t0.30 BRASS	
		C2680	
DIMENSIONS : MM		DWN: KS YEW	
TOLERANCE UNLESS OTHERWISE SPECIFIED:		CHK: SC CHOO	
X.XXX	+/-0.05	APVD: CHUANG	
X.XX	+/-0.10	SCALE : FREE	
X.X	+/-0.20	DRAWING NO:	
X	+/-0.50	A1453	
EFFECTIVE DATE :		13/7/07	
SHEET OF :		1 / 1	
REVISION:		PART NAME:	
01		040 SERIES TAB	
TOLERANCE UNLESS OTHERWISE SPECIFIED:		APPLICABLE (1) TERMINALS (2) HOUSING	
X.XXX +/-0.05		(1) 170402KM-2T	
X.XX +/-0.10		(2) —	
X.X +/-0.20			
X +/-0.50			

**EPI** Terminals & Connectors  
Elamp Precision Industry(M) Sdn.Bhd.