

SPECIFICATION DRAWING

MASTER COPY

ITEM NO	MATERIAL	TREATMENT	QTY/REEL	REEL/CARTON	MATCHING PART(S)
270702M-2T	t0.3 BRASS (C2680)	PRE-TIN PLATED	4000 PCS	5	TERMINAL-170702 HOUSING-070 SERIES

SYMBOL	DESCRIPTION
○	DIMENSION INSPECTED DURING SETUP AND OUTGOING.
□	DIMENSION INSPECTED HOURLY.
SPC	STATISTICALLY CONTROLLED DIMENSION.
△	JIG USED DURING INSPECTION.

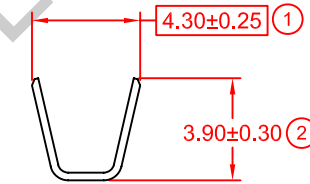
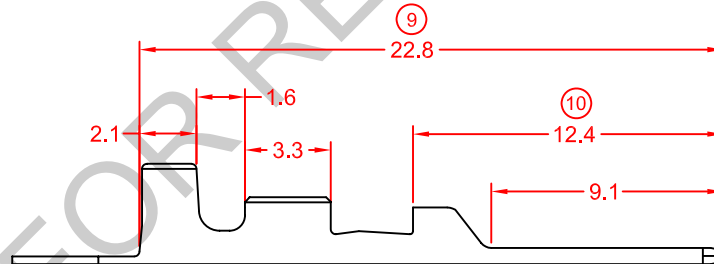
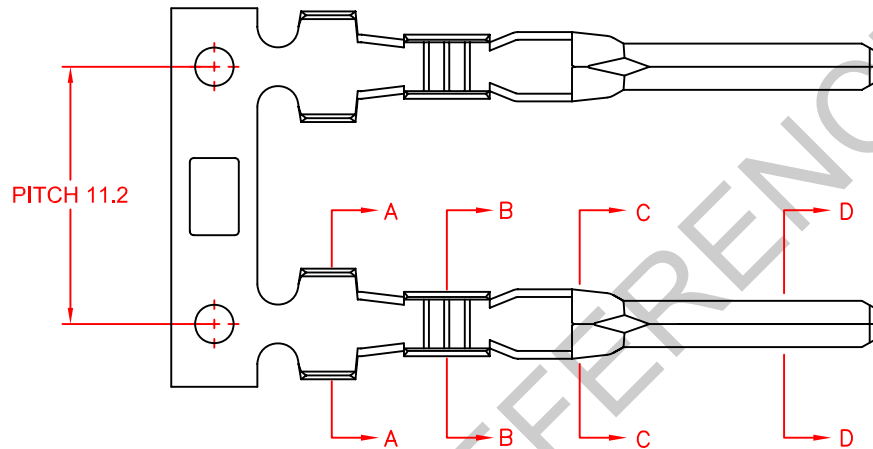
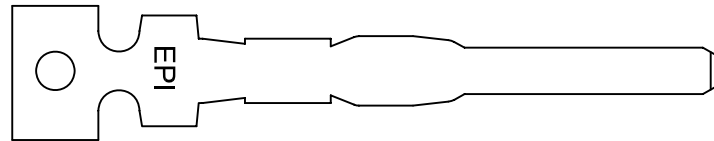
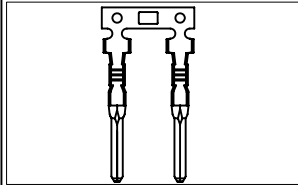

SECTION A-A

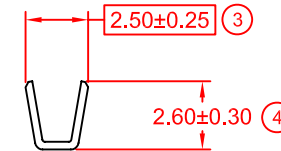

SECTION B-B

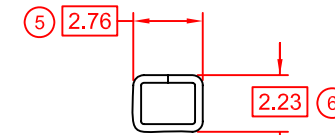

SECTION C-C

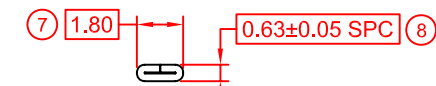

SECTION D-D

REMARKS:

- a) PLATING THICKNESS MIN 40μ INCH
- b) SUGGESTED WIRE INSULATION (O.D): 2.3MM
- c) SUGGESTED WIRE RANGE: 0.57~0.25MM² (AWG18~22)

REV.	DATE	AMENDMENT	ECR NO:	REVISION:	GENERAL TOLERANCE UNLESS SPECIFIED:	PREPARE BY:	REVIEWED BY:
03	16/8/11	UPDATE TO NEW FORMAT	-	03	X.XXX ±0.05 X.XX ±0.10 X.X ±0.20 X ±0.50	KS YEW	CH ANG
				⊕			APPROVED BY: CY CHUANG
				SHEET OF: 1 / 1	EFFECTIVE DATE: 16/8/11	SCALE : FREE UNIT : MM	ITEM NAME: 070 SERIES TAB ITEM NO: 270702M-2T DRAWING NO: EP-Q-325A

EPI Elamp Precision Industry(M) Sdn.Bhd.