

# TERMINALS SPECIFICATION DRAWING

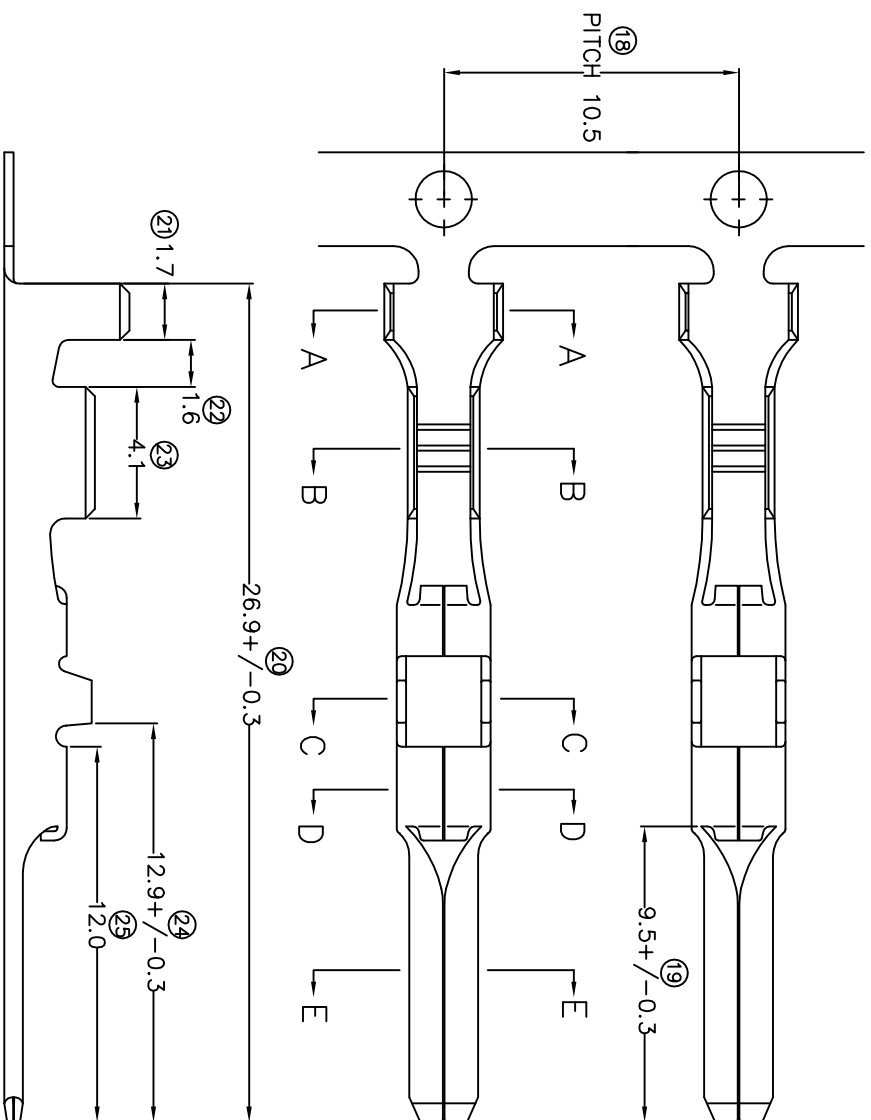

FOR REFERENCE ONLY

- 7) CRIMPING WIRE TENSILE FORCE IS BASE ON COPPER BREAK OFF INTENSITY.
- 6) TEMPERATURE RANGE -40°C TD +120°C.
- 5) VDL TAGE-MAX [VDLTS] PER WIRE SPECIFICATION.
- 4) THICKNESS PLATING MORE THAN 40µ INCH.
- 3) PACKING QTY : 5000 PCS/REEL.
- 2) WIRE INSULATION (O.D) : 2.3MM.
- 1) APPLICABLE WIRE RANGE : 1.21-0.54MM<sup>2</sup>.

SPECIFICATION :

<b>MATERIAL:</b> t0.30 BRASS C2680		<b>PRE-TIN PLATED</b> TREATMENT SELECTIVE		27090M-2T PART NUMBER	
<b>DIMENSIONS : MM</b>		DWN: KS YEW		<b>Terminals &amp; Connectors</b> Elamp Precision Industry(M) Sdn.Bhd. PART NAME: 090 SERIES TAB APPLICABLE (1) TERMINALS (2) HOUSING (1) 17090 (2) 090 SERIES HOUSING	
TOLERANCE UNLESS OTHERWISE SPECIFIED:		CHK: SC CHOO YL APVD: CHUANG			
X:XXX +/-0.05 X:XX +/-0.10 X:X +/-0.20 X +/-0.50		SCALE : FREE DRAWING NO:			
SHEET OF : 1 / 1		EFFECTIVE DATE : 13/7/07		A1344-1	

