

TERMINALS SPECIFICATION DRAWING

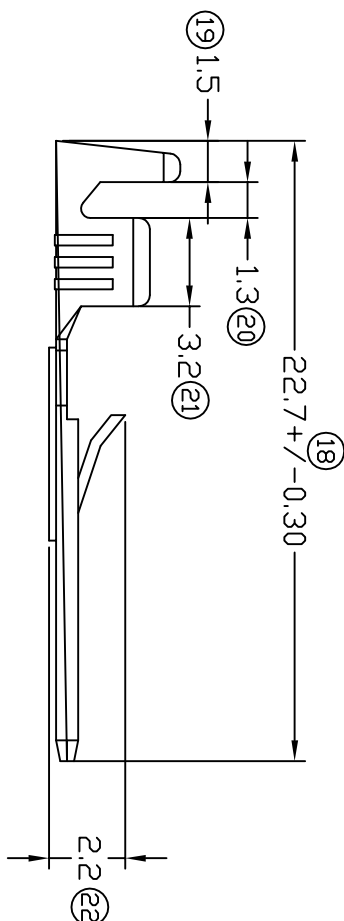
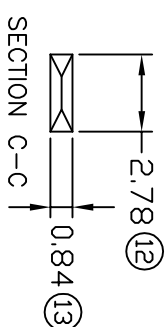
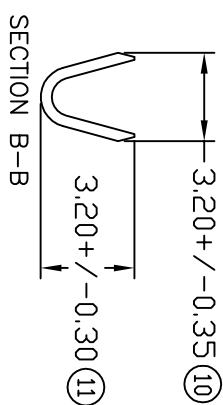
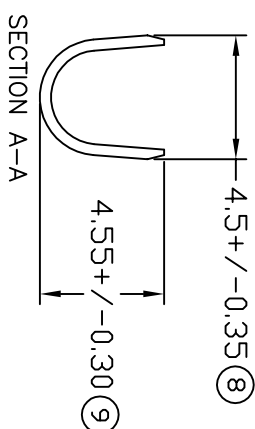
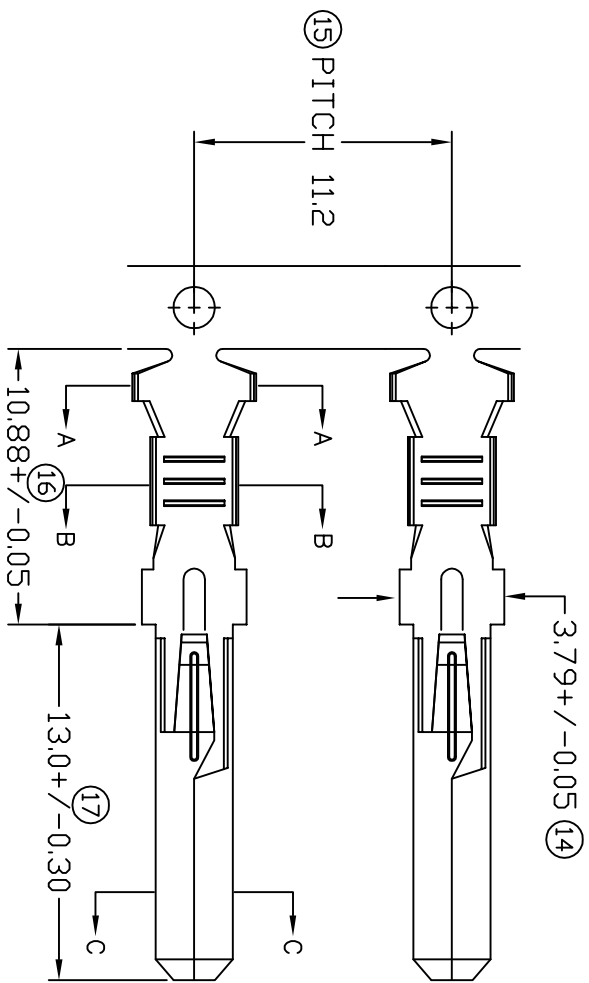

FOR REFERENCE ONLY

- 7) CRIMPING WIRE TENSILE FORCE IS BASE ON COPPER BREAK OFF INTENSITY.
- 6) TEMPERATURE RANGE -40°C TO +120°C.
- 5) VOLTAGE-MAX [VOLTS] PER WIRE SPECIFICATION.
- 4) THICKNESS PLATING MORE THAN 40μ INCH.
- 3) PACKING QTY : 4000 PCS/REEL.
- 2) WIRE INSULATION (O.D.) : 2.7MM.
- 1) APPLICABLE WIRE RANGE : 1.19-0.61MM².

SPECIFICATION :

MATERIAL: t0.40 BRASS C2680	PRE-TIN PLATED 27116M-2T		
DIMENSIONS : MM	TREATMENT SELECTIVE	PART NUMBER	
TOLERANCE UNLESS OTHERWISE SPECIFIED:	DWN: KS YEW	EPi Terminals & Connectors Elamp Precision Industry(M) Sdn.Bhd.	
X.XXX +/-0.05 X.XX +/-0.10 X.X +/-0.20 X +/-0.50	CHK: SC CHOO APVD: CHUANG SCALE : FREE DRAWING NO:	PART NAME: 110 SERIES TAB APPLICABLE (1) TERMINALS (2) HOUSING	
EFFECTIVE DATE : 31/10/07	A1222	(1) -	(2) AL1304H7-NT
REVISION: 09			
SHEET OF : 1 / 1			