

TERMINALS SPECIFICATION DRAWING

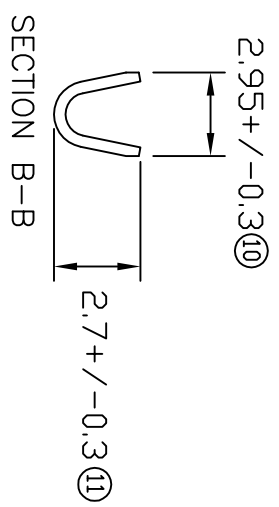
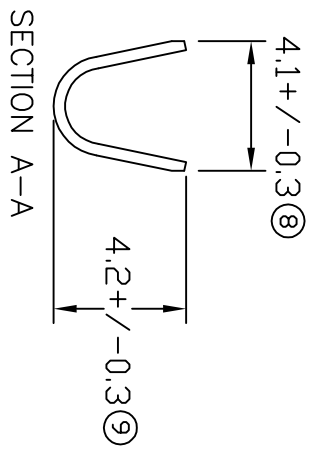
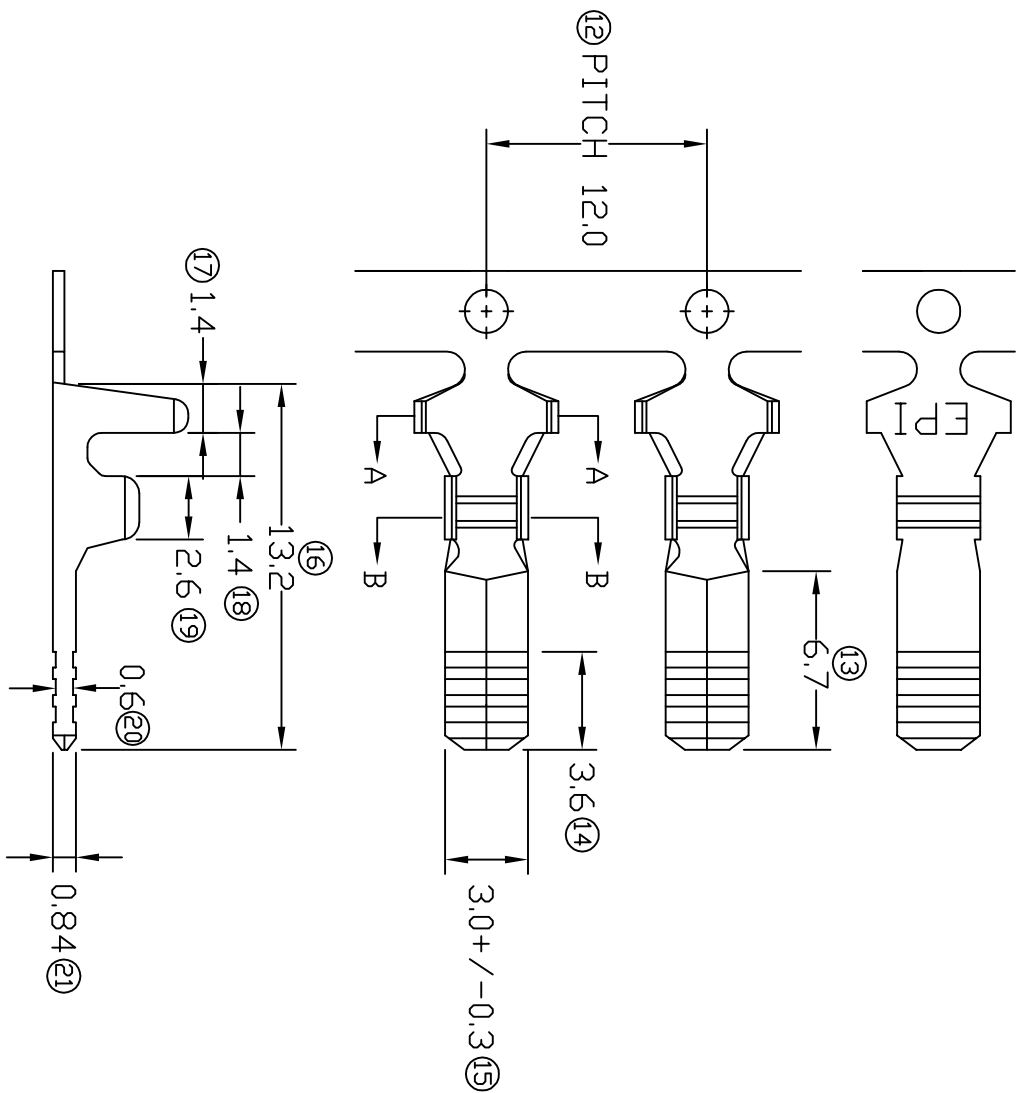

FOR REFERENCE ONLY

- 7) CRIMPING WIRE TENSILE FORCE IS BASE ON COPPER BREAK OFF INTENSITY.
- 6) TEMPERATURE RANGE -40°C TO +120°C.
- 5) VOLTAGE-MAX [VOLTS] PER WIRE SPECIFICATION.
- 4) THICKNESS PLATING MORE THAN 40μ INCH.
- 3) PACKING QTY : 4000 PCS/REEL.
- 2) WIRE INSULATION (O.D) : 2.4MM.
- 1) APPLICABLE WIRE RANGE : 0.84-0.43MM².

MATERIAL: t0.40 BRASS C2680		TREATMENT NONE		PART NUMBER 27118M-1	
DIMENSIONS : MM		DWN: KS YEW		PART NAME: EPI Terminals & Connectors Elamp Precision Industry(M) Sdn.Bhd.	
TOLERANCE UNLESS OTHERWISE SPECIFIED:		CHK: SC CHOO		PART NAME: 118 SERIES TAB	
X.XXX	+/-0.05	APVD: YL	APPLICABLE (1) TERMINALS (2) HOUSING		
X.XX	+/-0.10	SCALE : FREE			
X.X	+/-0.20	DRAWING NO:			
X	+/-0.50	EFFECTIVE DATE : 31/10/07	A1421	(1) 17150PM(0.8)-1 (2) -	
REVISION: 03		SHEET OF : 1 / 1			

SPECIFICATION :