

TERMINALS SPECIFICATION DRAWING

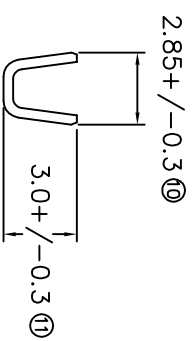
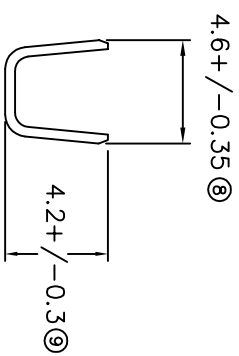
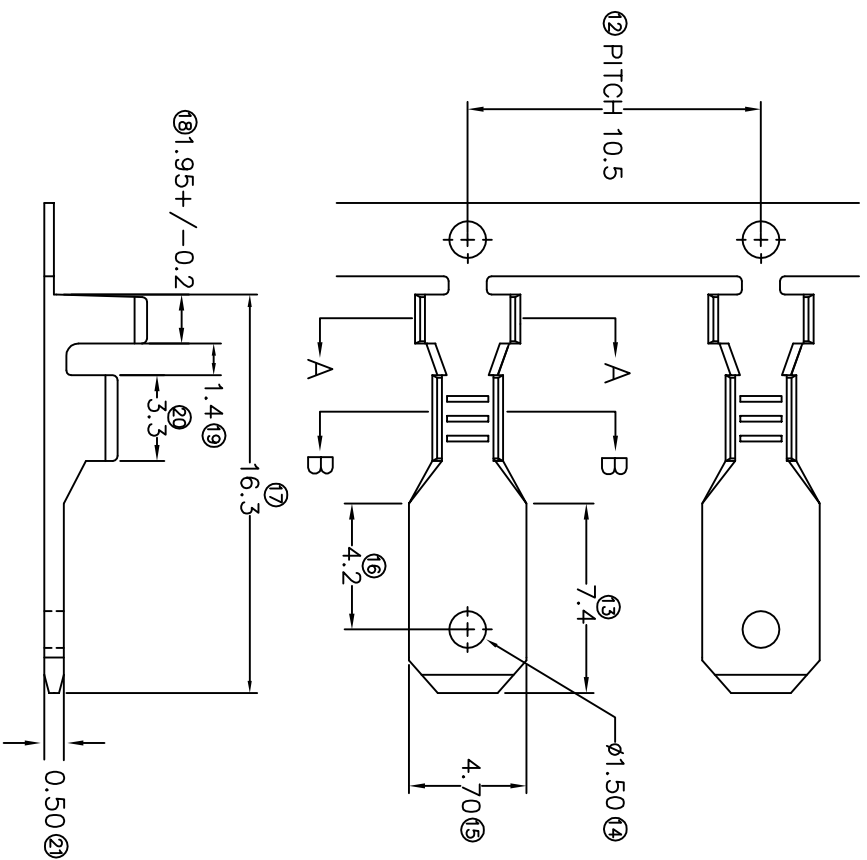

FOR REFERENCE ONLY

- 7) CRIMPING WIRE TENSILE FORCE IS BASE ON COPPER BREAK OFF INTENSITY.
- 6) TEMPERATURE RANGE -40°C TO +120°C.
- 5) VOL TAGE-MAX (VOLT)S PER WIRE SPECIFICATION.
- 4) THICKNESS PLATING MORE THAN 40µ INCH.
- 3) PACKING QTY : 5000 PCS/REEL.
- 2) WIRE INSULATION (D.D) : 2.3MM.
- 1) APPLICABLE WIRE RANGE : 0.93-0.47MM².

SPECIFICATION :

MATERIAL: 10.50 BRASS	PRE-TIN PLATED	271874M-2T
C2680	NONE	271874M-1
DIMENSIONS : MM	TREATMENT SELECTIVE	PART NUMBER
DWN: KS YEW	EPI Terminals & Connectors Elamp Precision Industry(M) Sdn.Bhd.	
TOLERANCE UNLESS OTHERWISE SPECIFIED:	CHK: SC CHOO	PART NAME:
X.XXX +/-0.05	APVD: CHUANG	187 SERIES TAB
X.XX +/-0.10	SCALE : FREE	APPLICABLE (1) TERMINALS (2) HOUSING
X.X +/-0.20	DRAWING NO:	(1) 187 (0.5) TYPE SERIES TERMINALS
X +/-0.50	A1268	(2) -
EFFECTIVE DATE : 23/7/07		
REVISION: 03		
SHEET OF : 1 / 1		