

# SPECIFICATION DRAWING

MASTER COPY

ITEM NO	MATERIAL	TREATMENT	QTY/REEL	REEL/CARTON	MATCHING PART(S)
28051AS-1	t0.35 BRASS (C2680)	NONE	8000 PCS	4	TERMINAL-18051AS
28051AS-2	t0.35 BRASS (C2680)	TIN PLATING	8000 PCS	4	HOUSING-N/A

SYMBOL	DESCRIPTION
○	DIMENSION INSPECTED DURING SETUP AND OUTGOING.
□	DIMENSION INSPECTED HOURLY.
SPC	STATISTICALLY CONTROLLED DIMENSION.
△	JIG USED DURING INSPECTION.

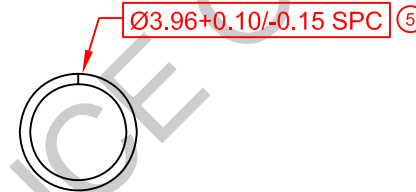
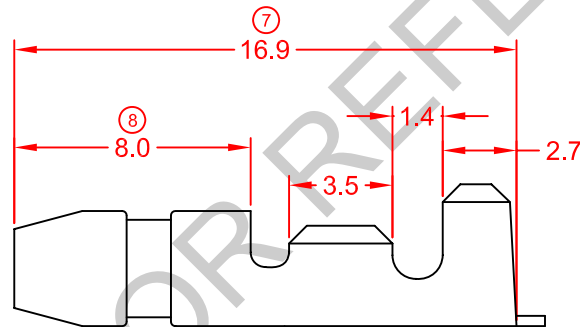
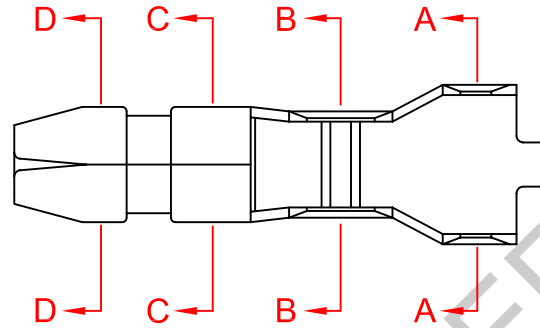
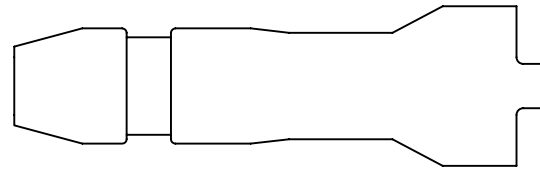
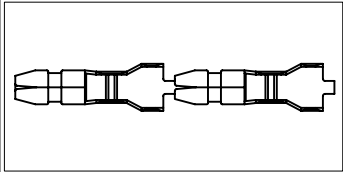

SECTION C-C

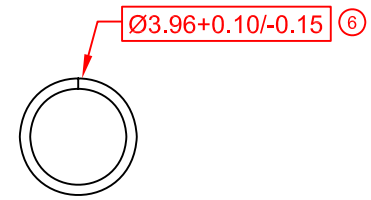

SECTION D-D

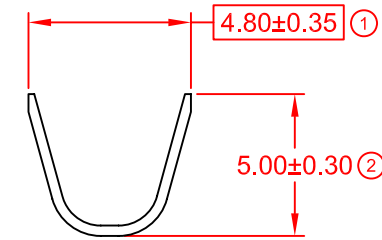

SECTION A-A

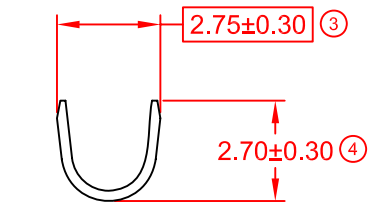

SECTION B-B

**REMARKS:**

- a) PLATING THICKNESS MIN 40μ INCH
- b) SUGGESTED WIRE INSULATION (O.D): 2.8MM
- c) SUGGESTED WIRE RANGE: 0.62~0.28MM<sup>2</sup> (AWG16~20)

					GENERAL TOLERANCE UNLESS SPECIFIED:	PREPARE BY: KS YEW	Elamp Precision Industry(M) Sdn.Bhd.
				REVISION: 07	X.XXX ±0.05 X.XX ±0.10 X.X ±0.20 X ±0.50	REVIEWED BY: CH ANG	
						APPROVED BY: CY CHUANG	ITEM NO: 28051AS-1, 2
07	14/9/11	UPDATE TO NEW FORMAT	-	SHEET OF: 1 / 1	EFFECTIVE DATE: 14/9/11	SCALE : FREE UNIT : MM	DRAWING NO: EP-Q-167A
REV.	DATE	AMENDMENT	ECR NO:				